

**SKITRAB**

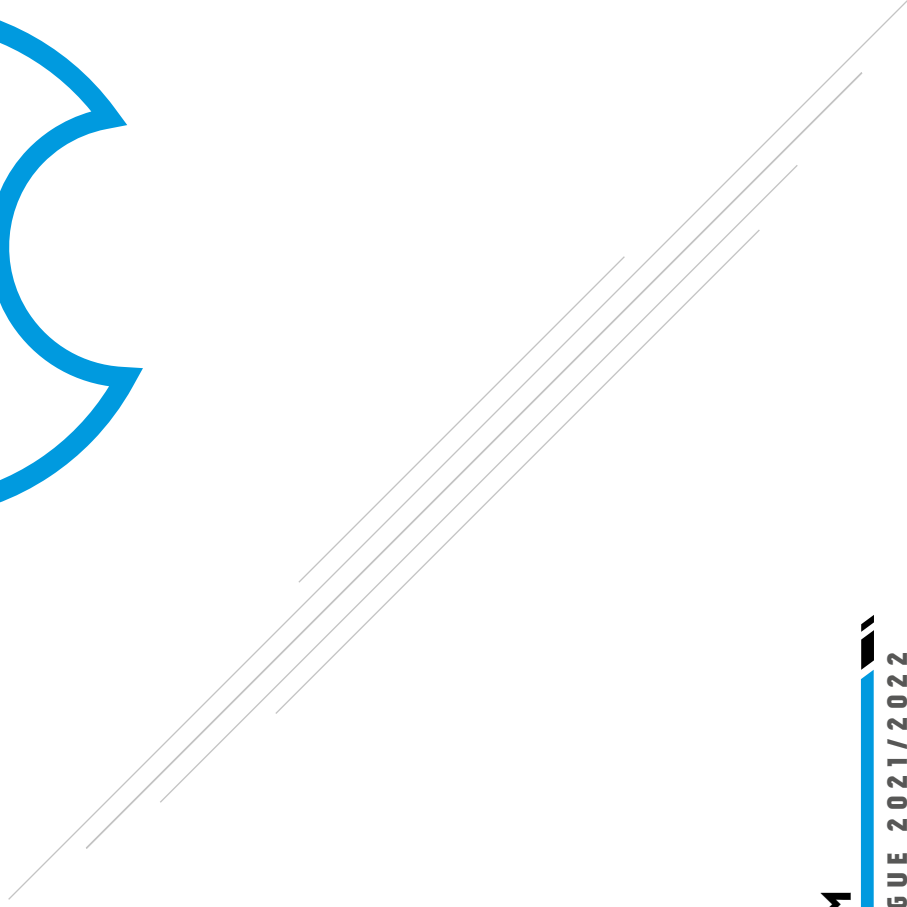

**SKITRAB.COM**

PRODUCT CATALOGUE 2021/2022



## UNA SINTESI DI TRADIZIONE ED INNOVAZIONE TECNOLOGICA

**SKI TRAB** è nata dall' intuizione e dalla passione di **GIACOMO TRABUCCHI** che nel **1946** costruì i primi sci in legno massiccio. **SKI TRAB** ha la sede produttiva a Bormio, nota stazione turistica, terra di professionisti e campioni. Da allora il costante e naturale contatto con la gente della montagna, ha contribuito allo sviluppo di un prodotto vicino alle vere esigenze degli sciatori. Bormio non è semplicemente il paese di montagna dove vengono prodotti gli sci **SKITRAB**.

"Made in Bormio" è un'affermazione che simbolizza un prodotto progettato, sviluppato e costruito da un'Azienda e da Persone che sono attivi esperti in materia di montagna, di scialpinismo e di sci di fondo. Tutti i prodotti **SKITRAB** si basano sull' esperienza, competenza e conoscenza accumulate in quasi 70 anni di sci, vita e lavoro sulla neve. Skitrab capisce lo sport, lo spirito e la cultura dello sci e lo vive ogni giorno. Vi invitiamo ad unirvi a noi nello scialpinismo e a condividere l'esperienza di sciare con i migliori sci del mondo.

## A MIX OF TRADITION AND INNOVATIVE TECHNOLOGY

**SKI TRAB** started up thanks to **GIACOMO TRABUCCHI'S** intuition and enthusiasm. Trabucchi made his first solid wooden skis in **1946**. The **SKI TRAB** factory is based in Bormio, a renowned skiing resort, boasting a tradition of professionals and champions given to the world of sport. Since its beginning there has always been a constant and natural contact with mountain experts. Bormio it's not simply the mountain village in Italy where **SKITRAB** products are manufactured. "Made in Bormio" is a statement that symbolizes a product that was designed, developed and manufactured by a company and people that are active experts in big mountain, backcountry and Nordic skiing. All the skitrab products are based on experience, expertise and knowledge we have developed by quite 70 years of skiing, living and working in the snow. **SKITRAB** understands the sport, spirit and culture of skiing and we live it every day. We invite you to join us in the backcountry and to share the experience of skiing on the best skis in the world.



## SKITRAB SKIS MADE IN BORMIO

### RICERCA

Lo sci viene progettato, costruito, analizzato e testato nella nostra sede di Bormio. Una sofisticata tecnologia per produrre gli sci prototipi e quindi testarli in laboratorio in ogni fase fisica e dinamica.

La nostra sfida maggiore è quella di ripensare lo sci arricchendo il suo codice genetico, dotandolo di innovative tecnologie perchè possa essere semplicemente migliore.

L'obiettivo non è solo la scorrevolezza.

La qualità di uno sci dipende anche dal suo modo di stare sulla neve, dalla stabilità e dalla capacità di adattarsi ai diversi terreni. La tecnologia Scarabeo, l'anima alveolare in Aramide, i nuovi Flex ed i nuovi profili fanno sì che lo sci SKI TRAB abbia un'ottima qualità di costruzione strutturale che favorisce il lavoro specifico sulla scorrevolezza.

### RESEARCH

TRAB skis are designed, developed, manufactured and tested in our factory in Bormio.

All ski prototypes and moulds are hand-made at SKI TRAB using advanced technology that allows immediate physical, structural and dynamic testing in our world class laboratory.

Our greatest challenge was to redesign the ski, enrich its genetic code, using innovative technology so it can be, simply, better.

Our aim is not only glide performance.

The quality of a ski also depends on the way it behaves on the snow,

its stability and ability to adapt to different terrain conditions. SKI TRAB's SCARABEO technology, the aramid honeycomb core and the new flex and profiles provide skis with an excellent structural construction which facilitates the specific work to improve gliding.

### TECNOLOGIA IN COSTANTE EVOLUZIONE

La passione per l'innovazione e l'altissima qualità tecnica necessaria per la realizzazione dei nostri progetti rendono necessario un continuo e crescente aggiornamento tecnologico, sia a livello di macchinari impiegati in produzione che a livello di capacità esecutiva da parte del nostro staff.

Le fasi di finitura prima e di controllo della qualità poi necessitano di altrettanta attenzione e tecnologia nonchè di manodopera esperta.

Affidabilità e cura maniacale per i dettagli sono i fiori all'occhiello di SKI TRAB, una realtà dove artigianalità e alta tecnologia procedono di pari passo in una costante ricerca di miglioramento.

### TECHNOLOGY IN CONSTANT EVOLUTION

Our Passion for innovation and the extremely high quality technology required to carry out our projects make it is essential for us to stay ahead of the curve technologically, both in terms of the machines used during the production process and the execution capability of our staff.

The finishing and quality control phases also require just as much attention, technology and skilled manpower.

Reliability and an obsessive attention to detail are what set us apart; at SKI TRAB craftsmanship and cutting-edge technology move forward together in an unending search for improvement.

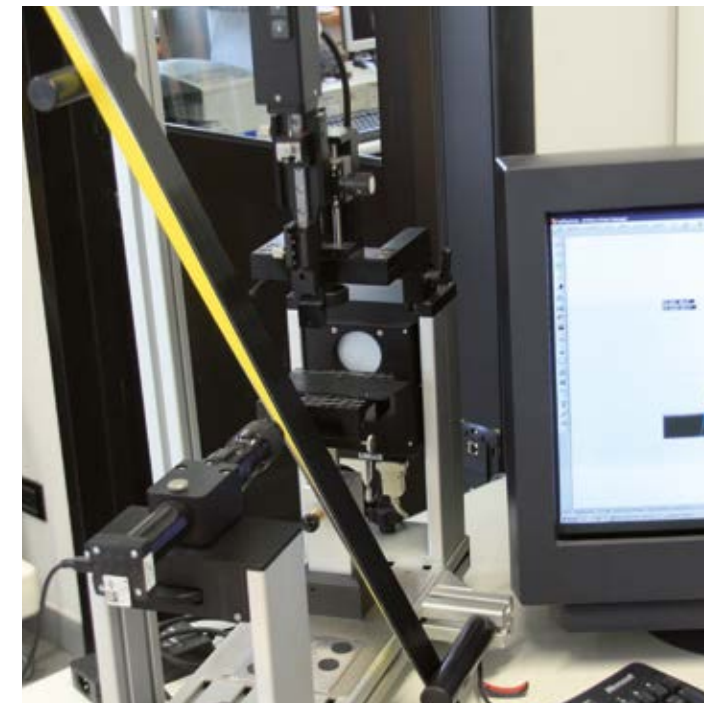

## SKITRAB SKIS MADE IN BORMIO

### TEST E SVILUPPO

Il costante e naturale contatto con la gente della montagna, dove viviamo e lavoriamo, ha contribuito allo sviluppo di un prodotto sempre più vicino alle esigenze di chi scia. La ricerca tecnologica non avrebbe senso senza la continua evoluzione in atto, possibile solo grazie al supporto dei migliori professionisti della montagna. Così ogni nuova tecnologia nasce dall'idea ben precisa di migliorare la performance, il comfort, di implementare la resistenza ed il divertimento, anche nelle condizioni più difficili. Con noi collaborano infatti i migliori atleti, i professionisti, e tanti che come noi hanno fatto della sfida e del migliorarsi continuamente il loro obiettivo.

### TEST & DEVELOPMENT

Constant contact with people from the mountains, where we live and work, has contributed to the development of a product which matches the demands of skiers. Technological research would be meaningless without constant evolution, only possible thanks to the support of the best mountain professionals. Every new technological breakthrough therefore stems from the clear objective of improving performance, comfort, resistance and fun, even in the most difficult conditions. The best athletes collaborate with us, as well as professionals and many more who like us are driven by new challenges and a constant desire to improve.

### FINITURE

In primis la scelta della soletta in polietilene sinterizzato con aggiunta di additivi quali la grafite, il fluoro e altri composti della nanotecnologia. Quindi un assemblaggio a bassa temperatura per avere un'ottima planarità e non alterare la stabilità molecolare della soletta. Infine una lavorazione accurata con l'ausilio di macchinari ad alta tecnologia con molti passaggi e lavorazioni collaudate per garantire la massima scorrevolezza già dal primo uso.

### FINISHING

First of all, the choice of a polyethylene sintered base with the addition of additives such as graphite, fluorine and other nanotechnology composites. Then a low-temperature assembling to obtain an excellent evenness and not modify the molecular stability of the base. Finally, a careful processing by means of high-technological machines using a variety of passages and tested processing to guarantee maximum glide from its first use.

### CONTROLLO QUALITÀ

In SKI TRAB ogni sci è sottoposto ad un accurato e metodico processo di controllo qualità in grado di monitorare ogni singola fase di produzione. SKI TRAB ha dedicato molta attenzione alla formazione del personale e a sensibilizzare gli addetti alla qualità del prodotto. Massima attenzione viene dedicata ad ogni singolo sci. Le aste vengono singolarmente siglate dal team in ogni fase produttiva per garantire un controllo dettagliato.

### QUALITY ASSURANCE

At SKI TRAB each ski undergoes a detailed and systematic quality assurance process that monitors quality through each individual phase of production. SKI TRAB has taken great care in training its staff in the methods and understanding of quality assurance and how important it is to build quality into every aspect of our skis. Every SKI TRAB ski is built with pride and attention to detail and is individually initialled by the team that built it.



  
**GLIDING TECH**  
TECHNOLOGIES TO IMPROVE GLIDING

# GLIDING TECHNOLOGY

## TECNOLOGIA DEL VELOCE

La scorrevolezza è per la Ski Trab come per il fondista il principale obiettivo.

Nello stabilimento di Bormio è stato messo a punto un processo produttivo dove ogni dettaglio è finalizzato a migliorare la scorrevolezza dello sci.

La fase di assemblaggio viene effettuata a bassa temperatura in modo da non alterare le caratteristiche dei materiali, quindi le dettagliate fasi di finitura vengono effettuate con tecniche in grado di mantenere le perfette qualità di origine della soletta.

Per soddisfare le diverse esigenze vengono proposti sci Cold e Plus con profili, sciancrature, solette e finiture adeguate alla neve fredda o meno.

## GLIDING TECHNOLOGY

Ease of glide is as important to Ski Trab as it is for the cross-country skier.

At our factory in Bormio, a production process has been developed where every detail is finished with this in mind. The assembly phase is carried out at a low temperature in order to preserve the characteristics of the materials, so the detailed finishing touches are added using techniques which perfectly preserve the original quality of the base.

In order to satisfy a variety of needs, there are two different types of ski available: Cold and Plus, with profile, side-cut, base and finish ideal for either cold or warmer snow conditions.



## TECNOLOGIA ARAMIDE

L'Aramide è una tra le più importanti fibre sintetiche. E' usata nella tecnologia aerospaziale e militare per le incredibili caratteristiche di resistenza. L'anima alveolare in Aramide rappresenta il miglior rapporto forza/leggerezza oggi sul mercato, SKI TRAB ha scelto il miglior materiale per mantenere alte nel tempo la stabilità, la performance e la durabilità dello sci.

## ARAMID TECHNOLOGY

Aramid is among the most important synthetic fibres. It is used in aerospace and military applications due to its incredible resistance features. The Aramid-honeycomb compound core represents the best strength/lightweight ratio available today on the market.

SKI TRAB has chosen the best material to obtain long-term high stability, performance and durability of the skis.

### THE ARAMID-HONEYCOMB COMPOUND CORE

(ARAMID, LIGHT WOOD, ASH)

REPRESENTS THE BEST STRENGTH/LIGHTWEIGHT RATIO AVAILABLE TODAY ON THE MARKET.

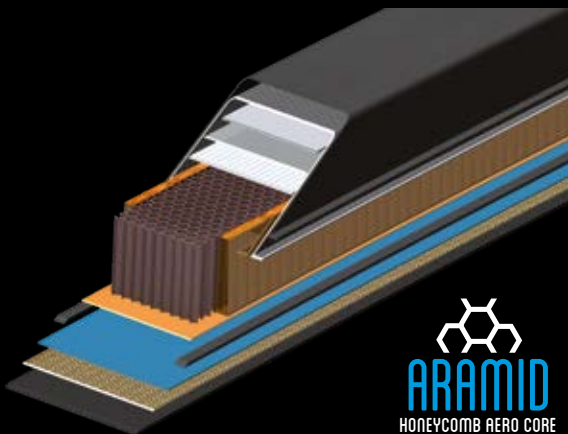
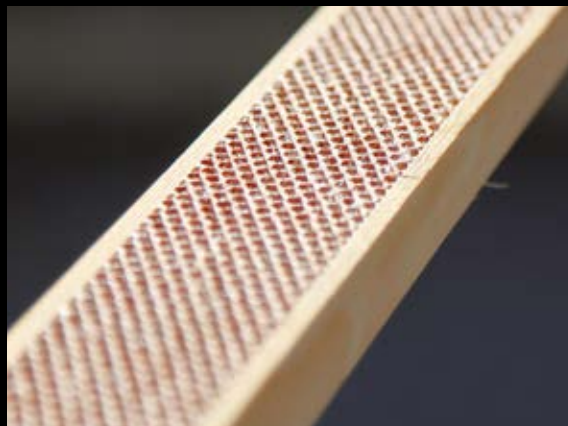

**ARAMID**  
HONEYCOMB AERO CORE

#### ARAMID / NOMEX

PLACE OF ORIGIN: EUROPE

USE: AEROSPACE AND AERONAUTIC

DENSITY: 70 KG M<sup>3</sup>

COMPRESSIVE STRENGTH MPA 10

CHARACTERISTICS: LIGHTWEIGHT, FLEXIBLE

+

#### LIGHT WOOD

PLACE OF ORIGIN: THE EAST

USE: WOODWORK, SKIS

DENSITY: 270/300 KG M<sup>3</sup>

COMPRESSIVE STRENGTH MPA 18

CHARACTERISTICS: LIGHTWEIGHT, EASY TO PROCESS

+

#### FRAXINUS L. / ASH TREE

PLACE OF ORIGIN: EUROPE

USE: BUILDING INDUSTRY, TOOLS, FUEL

DENSITY: 600/700 KG M<sup>3</sup>

COMPRESSIVE STRENGTH MPA 30

CHARACTERISTICS: SOLID AND HIGHLY FLEXIBLE

=

AERO CORE COMPONENTS

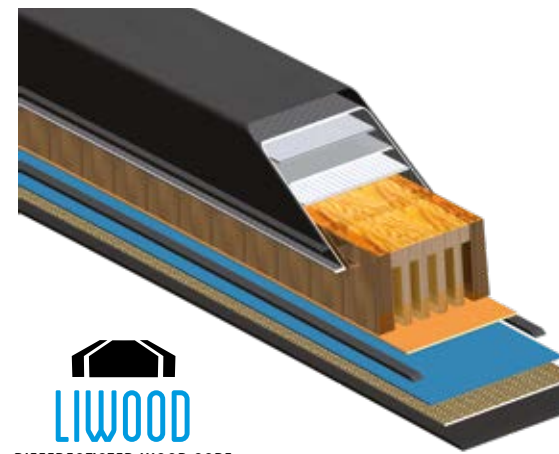

**LIWOOD**  
DIFFERENTIATED WOOD CORE

#### LIGHT WOOD

PLACE OF ORIGIN: THE EAST

USE: WOODWORK, SKIS

DENSITY: 270/300 KG M<sup>3</sup>

COMPRESSIVE STRENGTH MPA 18

CHARACTERISTICS: LIGHTWEIGHT, EASY TO PROCESS

+

#### HARD WOOD

PLACE OF ORIGIN: EUROPE

USE: BUILDING INDUSTRY, TOOLS, FUEL

DENSITY: 600/700 KG M<sup>3</sup>

COMPRESSIVE STRENGTH MPA 30

CHARACTERISTICS: SOLID AND HIGHLY FLEXIBLE

= LIWOOD CORE COMPONENTS

## LIWOOD CORE

Leggerezza e qualità alla portata di tutti: una nuova anima in legno leggero accoppiata con un fianco in legno più resistente e quindi avvolta in un box in fibra di vetro.

Lo sci rimane leggero e performante migliorando durata e resistenza. Il legno è la materia prima più usata negli sci. Da anni si è alla ricerca del legno leggero ma allo stesso tempo lo si vorrebbe duraturo e forte. Si va contro natura. L'anima in legno leggero deve essere supportata da lavorazioni e accoppiamenti con altri legni per migliorare la forza e soprattutto aiutata da materiali in composito che avvolgendola danno rigidità torsionale e durabilità.

## LIWOOD CORE

Lightweight and quality within everyone's reach .

A new light wood core reinforced with a fiberglass box wrapping around the skis provides light and high performance skis with durability and resistance. Wood is the most used raw material in ski production. For years designers have sought after a wood that is lightweight yet durable and strong, yet this goes against nature.

A lightweight wood core needs to be supported by production processes and to be mixed with other types of wood to improve its strength; above all it must be wrapped by composite materials which give it torsional rigidity and durability.

DUO SKINS  
NO WAX - SKINS TECHNOLOGY

# SKINS TECHNOLOGY

## DUO SKINS

Si tratta di una tecnologia che integra la pelle di foca con lo sci da fondo per evitare sciolinature.

Le pelli sono sagomate in due strisce aerodinamiche per aumentarne la scorrevolezza e inserite nella soletta e nella struttura stessa dello sci per rimanere esattamente coplanari con la base dello stesso.

Si crea così un piano di scorrimento perfetto.

E' possibile intercambiare pelli di diverso spessore e scorrevolezza o reinserire la soletta.

## DUO SKINS

It is a technology that integrates a mohair skin in the kick zone of the x-country skis to avoid waxing.

The mohair skins are shaped in two aerodynamic strips for an enhanced gliding and inserted in the base and in the ski structure itself in order to be precisely coplanar with the ski base, providing in this way a perfect gliding plane.

It is possible to replace the mohair inserts of different thickness and gliding performance or reposition the base.

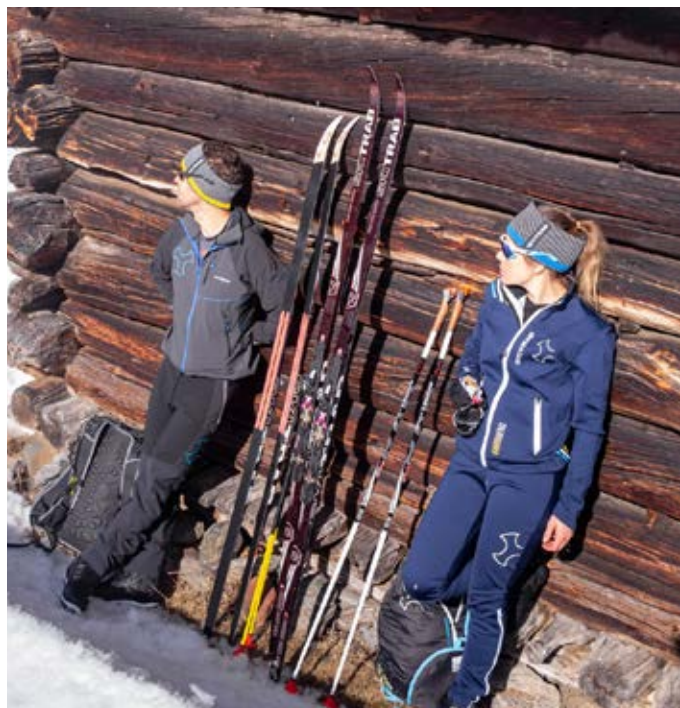



# FLEX TECHNOLOGY

## RACING FLEX

Ogni sci viene misurato e controllato con apparecchiature digitali che determinano la sua "carta d'identità".

Il segreto di uno sci da fondo performante sta nella scelta del corretto flex. Questo è caratterizzato da un profilo ad arco con geometrie e durezza differenti. Ogni asta sci viene misurata per individuare il target di utilizzo sulla base di peso e necessità.

## RACING FLEX

Each single ski is measured and checked by means of digital equipment that defines its "identification card".





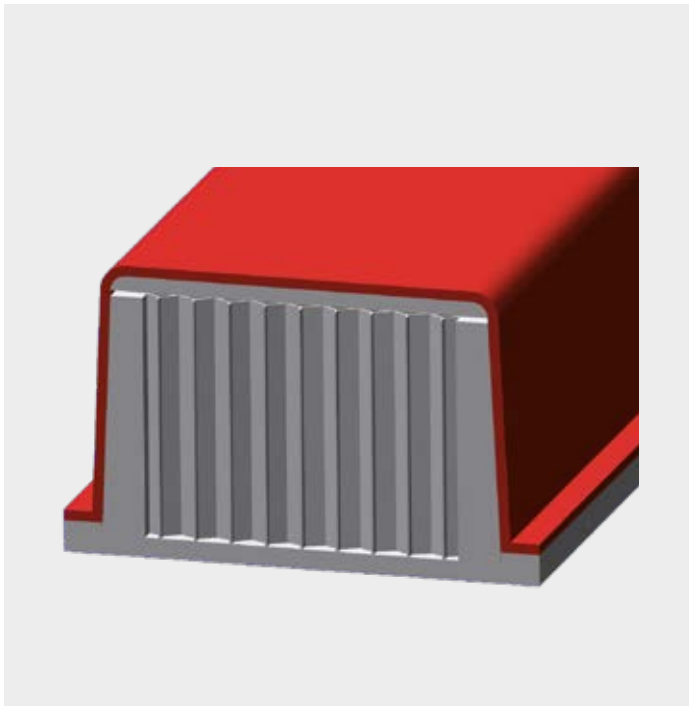

## SCARABEO

IMPROVING SKI EDGE STRENGTH

### SCARABEO TECH

Un profilo dello sci che evidenzia due “zampette laterali” costruite per dare forza e durabilità allo spigolo dello sci oltre che a rinforzare torsionalmente l’asta.

Molto utile anche perché permette di rifare lo spigolo dello sci senza incidere la struttura.

### SCARABEO TECH

A ski profile highlighting two “lateral little legs” to make the ski edge stronger and more durable besides strengthening the ski in torsion.

This is very useful also because it permits to reground the edge without affecting the finishing.



## DOUBLE POLING

SKI DESIGNED FOR DOUBLE POLING PUSH

### DOUBLE POLING

L’evoluzione della tecnica double poling ha portato allo sviluppo di uno sci specifico. Scorrevolezza e risposta durante la spinta con le braccia necessitano di un arco adeguato e di una misura specifica.

Lo sci si caratterizza per un ponte meno arcuato ma con maggior sostegno, utile in fase di spinta. Finiture e attenzioni sulla scelta e lavorazione soletta come nel meglio della tecnologia ed esperienza skitrab in fatto di scorrevolezza.

### DOUBLE POLING

The evolution of the double poling technique has led to the development of a specific ski. Glide and response while pushing down on the poles require an adequate camber and a specific measurement.

The ski is characterised by a camber with less arch but more support, useful in the push phase. The quality of the finish and the choice and grinding of the base using the best that Ski Trab experience and technology has to offer provides excellent glide.

# SKIS COLLECTION

GARA AERO SKATING R5



GARA AERO CLASSIC PR12



GARA AERO CLASSIC PR8



GARA AERO DOUBLE POLING



GARA AERO SKATING JUNIOR



GARA AERO CLASSIC JUNIOR



GARA COMP JUNIOR SKATE



GARA COMP JUNIOR CLASSIC



TEAM COMP SKATE



TEAM COMP CLASSIC



TEAM COMP CLASSIC CARVE



GARA AERO DUO SKIN



TEAM COMP DUO SKIN - TEAM COMP DUO SKIN EVO



TEAM COMP DUO SKIN JUNIOR



TEAM COMP SKIN CARVE



## GARA AERO SKIS

## GARA COMP JUNIOR SKIS

## TEAM COMP SKIS

## DUO SKIN SKIS

# PURE PERFORMANCE

## GARA AERO SKIS

La linea aereo rappresenta la scelta più evoluta in termini di performance, leggerezza e velocità. Vengono usate le migliori tecnologie e attenzioni, l'anima è leggerissima in Aramide alveolare.

Le finiture e le solette sono lavorate e trattate come quelle degli atleti di Coppa del Mondo. Ogni sci viene fornito con le misure del suo flex.

*The AERO line is our state-of-the-art model in terms of performance, lightweight and gliding. The best technologies and attention are used here, the aramid honeycomb core is extremely light in weight. The finishing and the base are processed and treated in the same way as the ones for World Cup athletes. Every ski is provided with the size of its flex.*

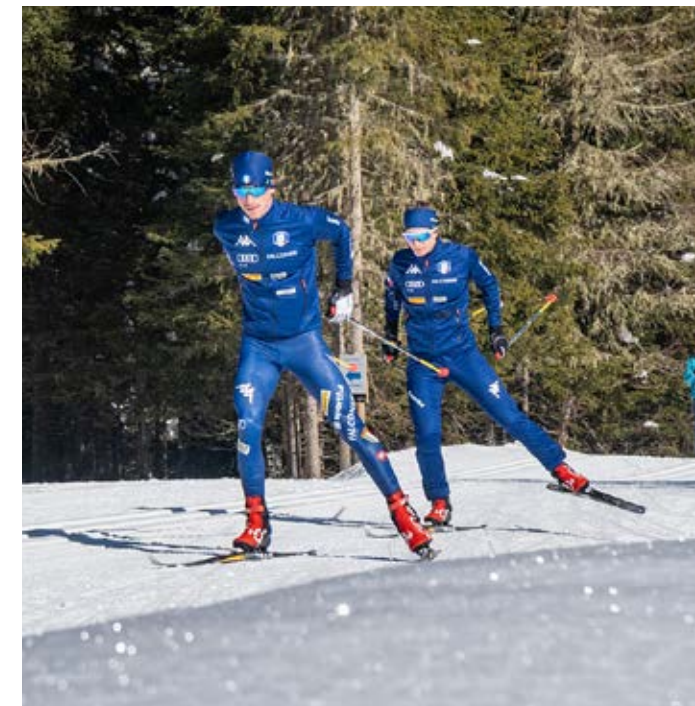

**GLIDING TECH**  
TECHNOLOGIES TO IMPROVE GLIDING



**ARAMID**  
HONEYCOMB AERO CORE



**RACING FLEX**  
HIGH PERFORMANCE PROFILE



**SCARABEO**  
IMPROVING SHI EDGE S



**DOUBLE POLING**  
SHI DESIGNED FOR DOUBLE POLING PUSH



THE ARAMID-HONEYCOMB COMPOUND CORE (ARAMID, LIGHT WOOD, ASH) REPRESENTS THE BEST STRENGTH/LIGHTWEIGHT RATIO AVAILABLE TODAY ON THE MARKET.

ARAMID

GLIDING TECH

SCARABEO

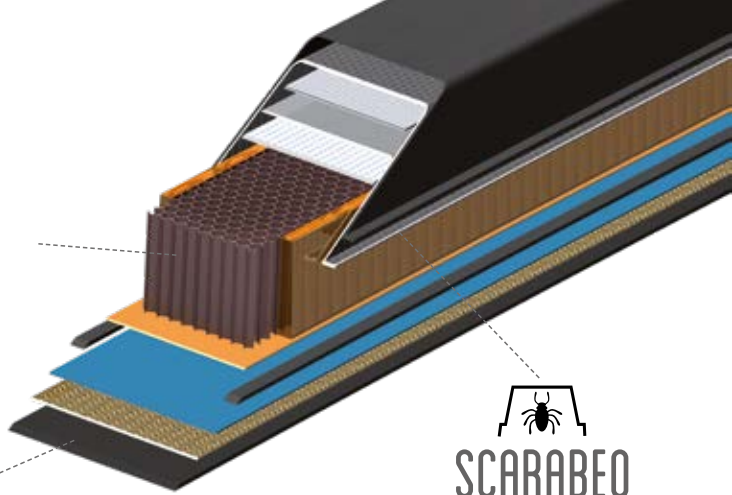

RACING FLEX

PROFILE R5 PLUS  
PROFILE R5 COLD  
PROFILE R5 PURE

CARBON REINFORCEMENTS

END-PROTECTION

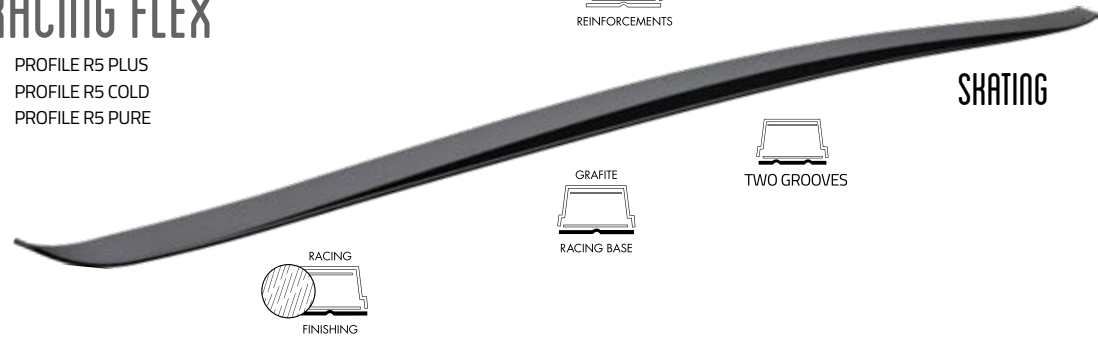

SKATING

GRAFITE RACING BASE

TWO GROOVES

RACING FINISHING

RACING FLEX

PROFILECLASSIC PR8 PLUS  
PROFILECLASSIC PR12 PLUS  
PROFILECLASSIC PR4 PLUS  
PROFILECLASSIC PR4 COLD

CARBON REINFORCEMENTS

END-PROTECTION

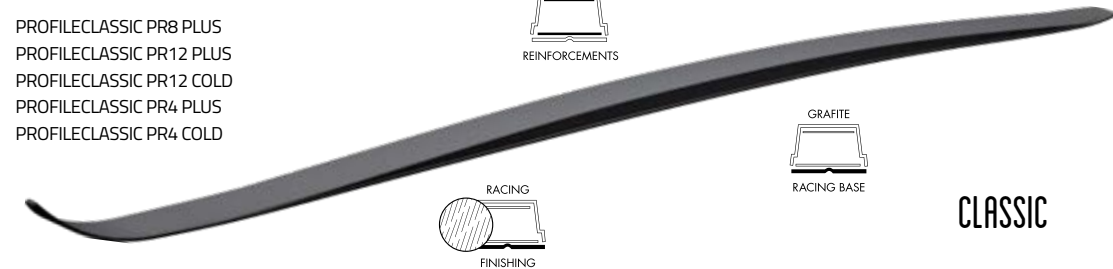

CLASSIC

RACING FINISHING

GRAFITE RACING BASE

## GARA AERO SKATING R5 cod. 12171C COLD - cod. 12171W PLUS

Racing SKATING skis with excellent glide performance and high stability. QUADRIAXIAL AERO TECH structure, extended camber, backward balance, utmost manoeuvrability with a good direction control and maximum glide performance.

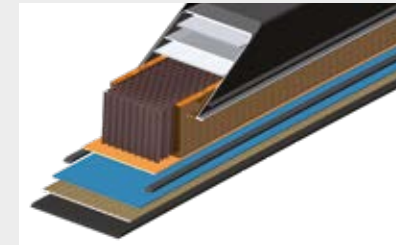

- . QUADRIAXIAL AERO TECH
- . CARBON REINFORCEMENTS
- . END PROTECTION
- . GRAPHITE RACING BASE
- . RACING FINISHING
- . TWO GROOVES

ARAMID HONEYCOMB AERO CORE

SIZE	HARDNESS	SIDECUT R5 COLD	SIDECUT R5 WARM	SIDECUT R5 PURE	WEIGHT
172 cm	medium	40.5	40.5	40.5	950 gr
179 cm	hard	44.5	44.5	44.5	size 186 cm
186 cm		44.5	44.5	44.5	
193 cm		42.5	42.5	42.5	

3 YEARS WARRANTY  
MADE IN BORMIO  
SINCE 1946

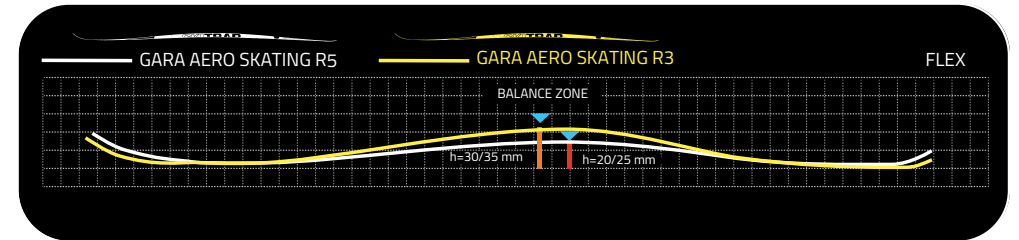

GLIDING TECH  
TECHNOLOGIES TO IMPROVE GLIDING

ARAMID  
HONEYCOMB AERO CORE

RACING FLEX  
HIGH PERFORMANCE PROFILE

SCARABEO  
IMPROVING SHI EDGE STRENGTH

# GARA AERO CLASSIC PR12 cod. 12173W12 PLUS - cod. 12173C12 COLD

Racing CLASSIC skis with excellent glide performance and utmost manoeuvrability. QUADRIAXIAL AERO TECH structure. Extremely lightweight skis with long PR12 camber and deformable short PR12 camber.

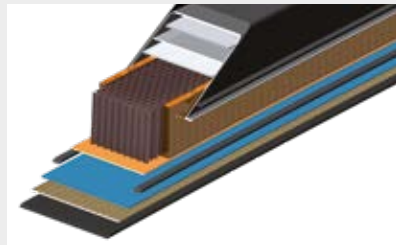

- . QUADRIAXIAL AERO TECH
- . CARBON REINFORCEMENTS
- . END PROTECTION
- . GRAPHITE RACING BASE
- . RACING FINISHING



SIZE	HARDNESS	SIDECUT PR10	RACE BASE	WEIGHT
198 cm	soft	41,0	COLD- PR12	1060 gr
205 cm	medium	44.5	PLUS- PR12	size 205 cm
	hard	44.5		

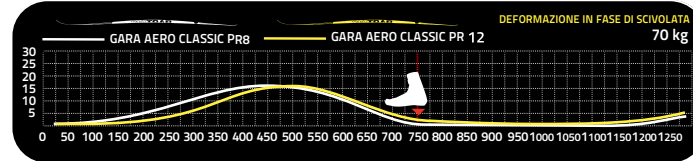
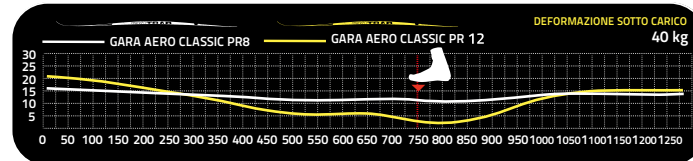
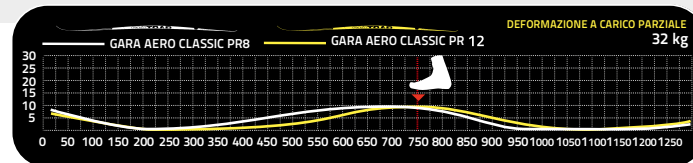

# GARA AERO CLASSIC PR8 cod. 12173W8 PLUS

Racing CLASSIC skis with excellent glide performance and utmost manoeuvrability. QUADRIAXIAL AERO TECH structure. Extremely lightweight skis with long PR8 camber and deformable short PR8 camber.

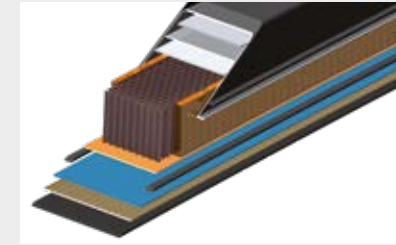

- . QUADRIAXIAL AERO TECH
- . CARBON REINFORCEMENTS
- . END PROTECTION
- . GRAPHITE RACING BASE
- . RACING FINISHING



SIZE	HARDNESS	SIDECUT PR8	RACE BASE	WEIGHT
198 cm	soft	41,0	PLUS-PR8	1060 gr
205 cm	medium	44.5		size 205 cm
	hard	44.5		

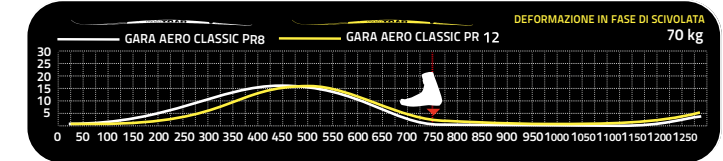
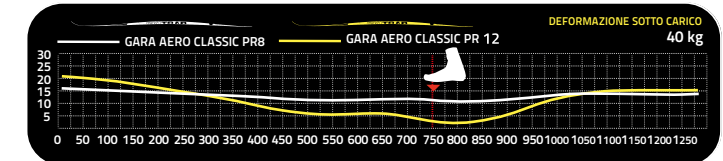
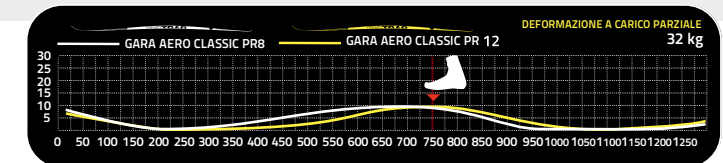

## GARA AERO DOUBLE POLING cod. 12175W PLUS - cod. 12175C COLD

Racing SKATING ski with excellent gliding performance and high stability: QUADRIAXIAL AERO TECH structure, particularly elastic, extended camber for a better response, direction control and glide.

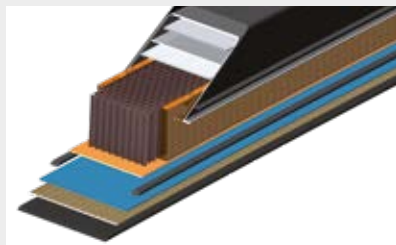

- . QUADRIAXIAL AERO TECH
- . CARBON REINFORCEMENTS
- . END PROTECTION
- . GRAPHITE RACING BASE
- . RACING FINISHING

**ARAMID**  
HONEYCOMB AERO CORE

SIZE	HARDNESS	SIDECUT	RACE BASE	WEIGHT
192 cm	medium	41,0	COLD-	1060 gr
199 cm	hard	44.5	PLUS-	size 199 cm
		44.5		

## GARA AERO SKATING JUNIOR cod. 12176

Racing SKATING skis with excellent gliding performance and high stability. QUADRIAXIAL AERO TECH structure, particularly elastic, extended camber for a better response, direction control and glide.

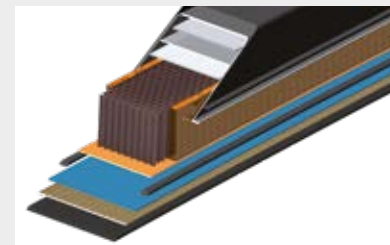

- . QUADRIAXIAL AERO TECH
- . CARBON REINFORCEMENTS
- . END PROTECTION
- . GRAPHITE RACING BASE
- . RACING FINISHING
- . TWO GROOVES

**ARAMID**  
HONEYCOMB AERO CORE

SIZE	HARDNESS	SIDECUT	WEIGHT
145cm	soft	<b>WARM</b>	950 gr
155 cm	medium	41.5	size 186 cm
165 cm	hard	44.2	
172 cm		42.0	





## GARA AERO CLASSIC cod. 12174W PLUS - cod. 12174C COLD JUNIOR cod. 12177 PLUS

Racing CLASSIC skis with excellent glide performance and utmost manoeuvrability. Ideal for young athletes. QUADRIAXIAL AERO TECH structure with aramid core and PR4 camber.

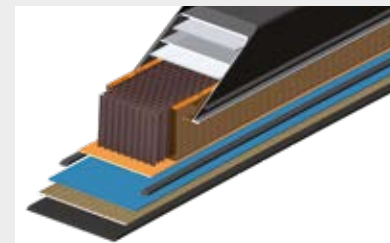

- . QUADRIAXIAL AERO TECH
- . CARBON REINFORCEMENTS
- . END PROTECTION
- . GRAPHITE RACING BASE
- . RACING FINISHING

**ARAMID**  
HONEYCOMB AERO CORE

### GARA AERO CLASSIC

SIZE	HARDNESS	SIDECUT	RACE BASE	WEIGHT
184 cm	soft	41,0	COLD-PR4	920 gr
191 cm	medium	44.5	PLUS-PR4	size 191 cm
	hard	44.5		

### GARA AERO CLASSIC JUNIOR

SIZE	HARDNESS	SIDECUT	RACE BASE	WEIGHT
150 cm	soft	41,0		920 gr
160 cm	medium	44.5	PLUS-PR4	size 191 cm
172 cm	hard	44.5		
177 cm				





## GARA COMP SKIS

Sci da gara junior con caratteristiche di scorrevolezza simili ai modelli Gara senior. Struttura cap quadraxial con anima liwood tech. Le finiture e le solette sono lavorate e trattate come quelle degli atleti di Coppa del Mondo. Ogni sci viene fornito con le misure del suo flex.

*Junior race skis with a glide similar to that of the regular race skis. Quadaxial cap construction with liwood tech core. The finish and base are produced and treated like those used by World Cup athletes. Every ski is supplied with its flex index.*

**GLIDING TECH**  
TECHNOLOGIES TO IMPROVE GLIDING



**LIWOOD**  
DIFFERENTIATED WOOD CORE

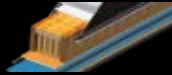

**RACING FLEX**  
HIGH PERFORMANCE PROFILE



**SCARABEO**  
IMPROVING SHI EDGE S



**RACING FLEX**

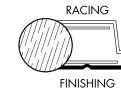

FINISHING



QUADRIAXIAL WOOD-TECH



RACING BASE



CARBON REINFORCEMENTS



TWO GROOVES



END-PROTECTION

SKATING

**RACING FLEX**

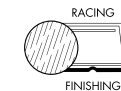

FINISHING



QUADRIAXIAL WOOD-TECH



CARBON REINFORCEMENTS



RACING BASE



END-PROTECTION

CLASSIC

**GLIDING TECH**

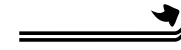

**LIWOOD**



**SCARABEO**

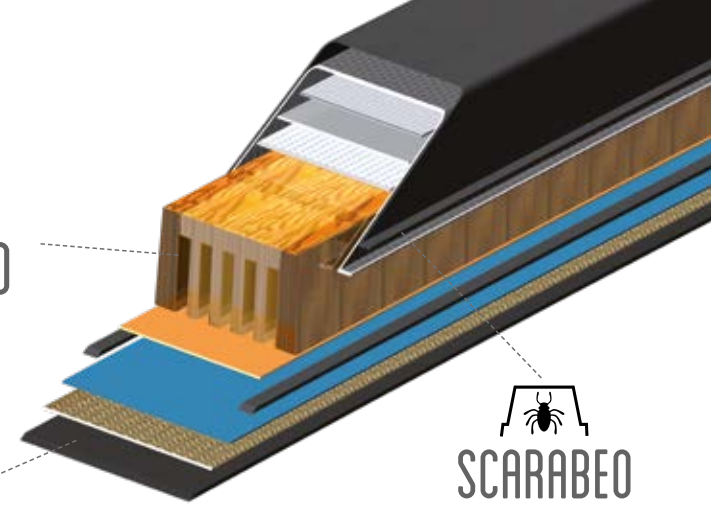



## GARA COMP SKATE JUNIOR cod. 12178

Racing CLASSIC skis with excellent glide performance and utmost manoeuvrability. Ideal for young athletes. QUADRIAXIAL AERO TECH structure with aramid core and PR4 camber.

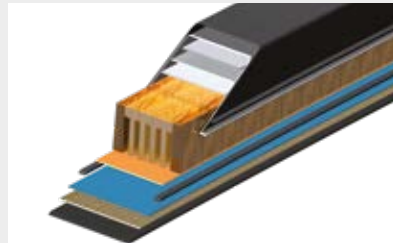

- . LIWOOD TECH
- . CARBON GLASS REINFORCEMENTS
- . END PROTECTION
- . RACING BASE
- . RACING FINISHING
- . TWO GROOVES



SIZE	HARDNESS	SIDECUT	BASE	WEIGHT
145 cm	soft	40.5	race PLUS	860 gr
155 cm	medium	44.2		size 165 cm
165 cm	hard	42.0		
172 cm				

## GARA COMP CLASSIC JUNIOR cod. 12179

Waxable racing CLASSIC skis, specifically designed for young athletes. Light wood and carbon fiber Cap LiWood Tech structure. Flexible short camber for an excellent grip and glide. Racing base with race finishing.

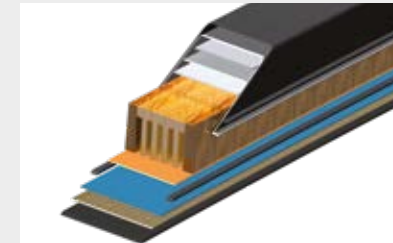

- . LIWOOD TECH
- . CARBON GLASS REINFORCEMENTS
- . END PROTECTION
- . RACING BASE
- . RACING FINISHING



SIZE	HARDNESS	SIDECUT	BASE	WEIGHT
150 cm	soft	41.0	race PLUS	850 gr
160 cm	medium	44.5		size 170 cm
170 cm	hard	44.5		
177 cm				
184 cm				





## COMP SKIS

Una linea di sci di ottima qualità con tecnologia Scarabeo Tech ed un'innovativa anima in legno leggero a canali d'aria LIWOOD TECH. Sci leggero, con ottima sciabilità e performance grazie a dettagli e tecnologie di costruzione derivati dalla linea gara aero.

*A high-quality ski line using Scarabeo technology together with an innovative LI-WOOD TECH lightweight wood core with air canals. Lightweight skis showing an excellent skiing performance thanks to construction details and technologies coming from the RACE AERO line.*

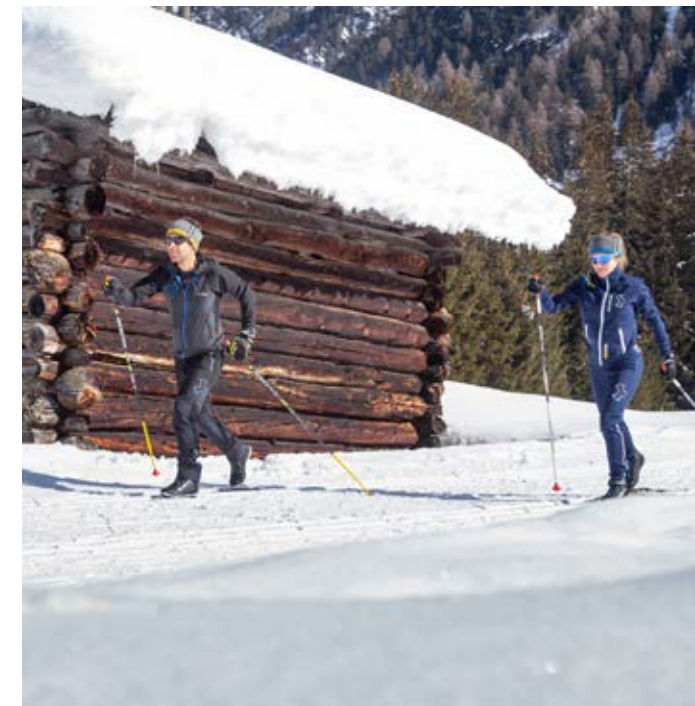

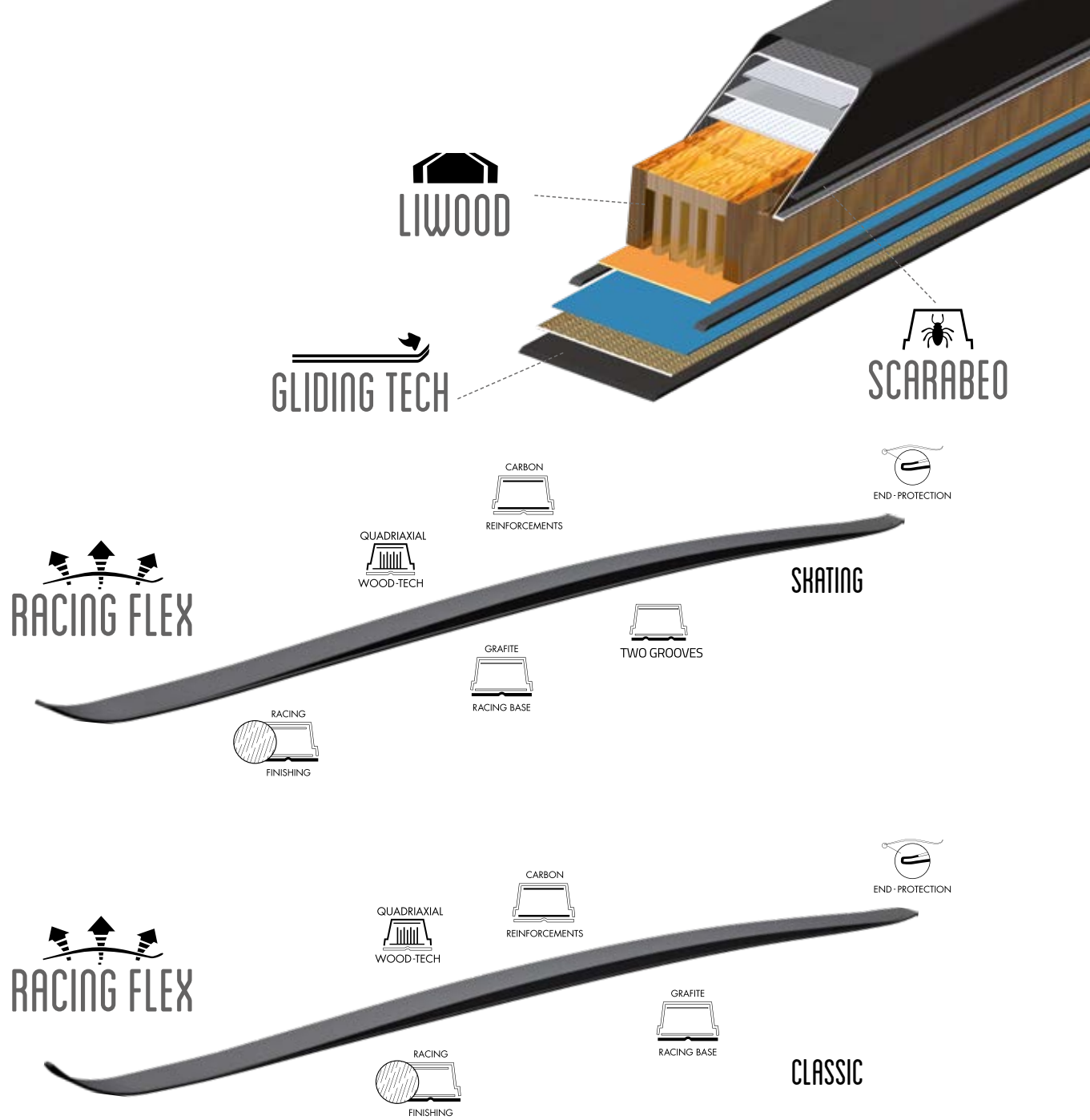

## TEAM COMP SKATE cod. 12147

SKATING skis suitable for skiers with a good technical level. The skis provide utmost stability and excellent edge grip, thanks to the special SCARABEO TECH structure. The edges can be ground several times so as to guarantee the best edge grip

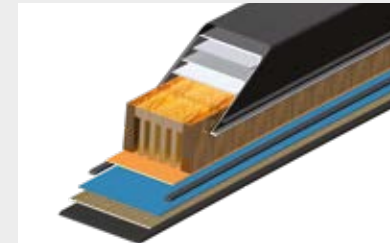

- . LIWOOD TECH
- . CARBON GLASS REINFORCEMENTS
- . END PROTECTION
- . RACING BASE
- . RACING FINISHING
- . TWO GROOVES

**LIWOOD**  
DIFFERENTIATED WOOD CORE

SIZE	HARDNESS	SIDECUT	BASE	WEIGHT
172 cm	soft	43.5	race universal	990 gr
179 cm	medium	44.5		size 179 cm
186 cm	hard	42.5		
193 cm				



## TEAM COMP CLASSIC cod. 12150

Waxable CLASSIC skis for able skiers, easy to manoeuver and lightweight. Light wood, fiberglass and carbon Cap LiWood Tech structure. The edges can be ground several times thanks to the special SCARABEO TECH structure of the skis.

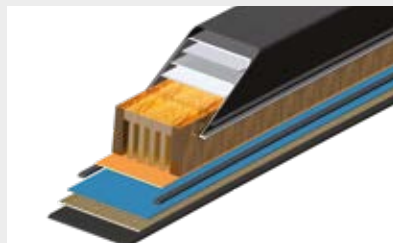

- . LIWOOD TECH
- . CARBON GLASS REINFORCEMENTS
- . END PROTECTION
- . RACING BASE
- . RACING FINISHING
- . TWO GROOVES



SIZE	HARDNESS	SIDECUT	BASE	WEIGHT
177 cm	soft	41.0	race universal	1040 gr
184 cm	medium	44.5		size 198 cm
191 cm	hard	44.5		
198 cm				
205 cm				

## TEAM COMP CLASSIC CARVE cod. 12161

Waxable CLASSIC skis for able skiers, easy to manoeuver, stable and lightweight. Light wood, fiberglass and carbon Cap LiWood Tech structure. The edges can be ground several times thanks to the special SCARABEO TECH structure of the skis. Skis with shallow side-cut to improve stability and edge grip.

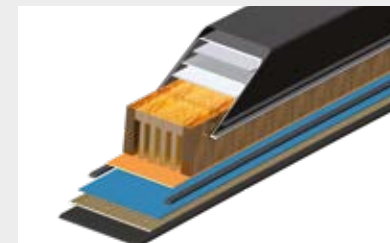

- . LIWOOD TECH
- . CARBON GLASS REINFORCEMENTS
- . END PROTECTION
- . RACING BASE
- . RACING FINISHING



SIZE	HARDNESS	SIDECUT	BASE	WEIGHT
177 cm	soft	48.0	race universal	1080 gr
184 cm	medium	45.0		size 198 cm
191 cm	hard	47.0		
198 cm				
205 cm				





## DUO SKIN SKIS

L'esperienza e la tradizione dello scialpinismo e dello sci da fondo sono integrate nella linea di sci da fondo con le pelli. Ski Trab ha sviluppato un sistema di tenuta su due strisce di pelli incassate nella struttura dello sci per offrire tenuta e scorrevolezza in base alle diverse esigenze.

Dal modello Gara Aero con caratteristiche che permettono performance vincenti nelle competizioni a sci turistici che offrono un ottimo grip abbinato sempre ad un'ottima sensazione di sciata.

*The experience and tradition of ski touring and cross-country skiing are combined in this line of cross-country skis with skins. Ski Trab has developed a grip system on two strips of skin embedded in the structure of the ski to offer both grip and glide depending on the various needs of the skier.*

*From the Race Aero model with features that equal winning race performance to recreational skis that offer excellent grip together as ever with a sensation of fluidity when skiing.*



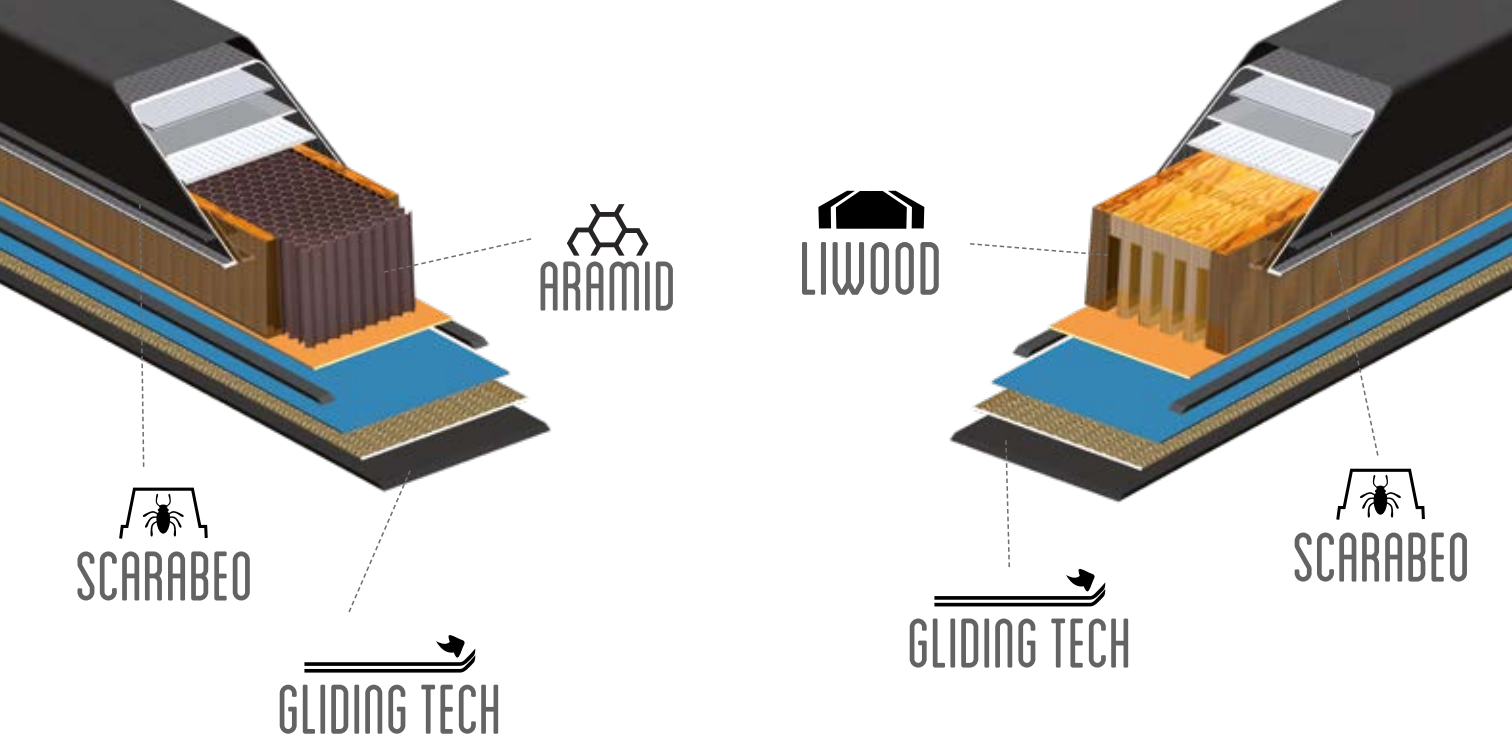

## GARA AERO DUOSKIN cod. 12172

Waxless training skins, suitable for long distance races. The DUO SKIN technology provides an excellent grip in all conditions and the special levelling of the mohair insert with the ski base ensures an outstanding glide performance. Replaceable mohair skin inserts.

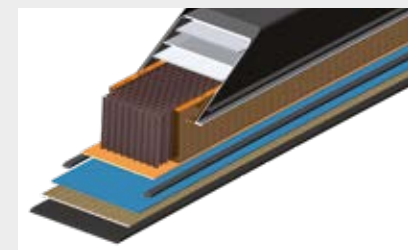

- . QUADRIAXIAL AERO TECH
- . CARBON REINFORCEMENTS
- . END PROTECTION
- . GRAPHITE RACING BASE
- . RACING FINISHING



SIZE	HARDNESS	SIDECUT	WEIGHT
184 cm	soft	41,0	1020 gr
191 cm	medium	44,5	size 198 cm
198 cm	hard	44,5	
205 cm			

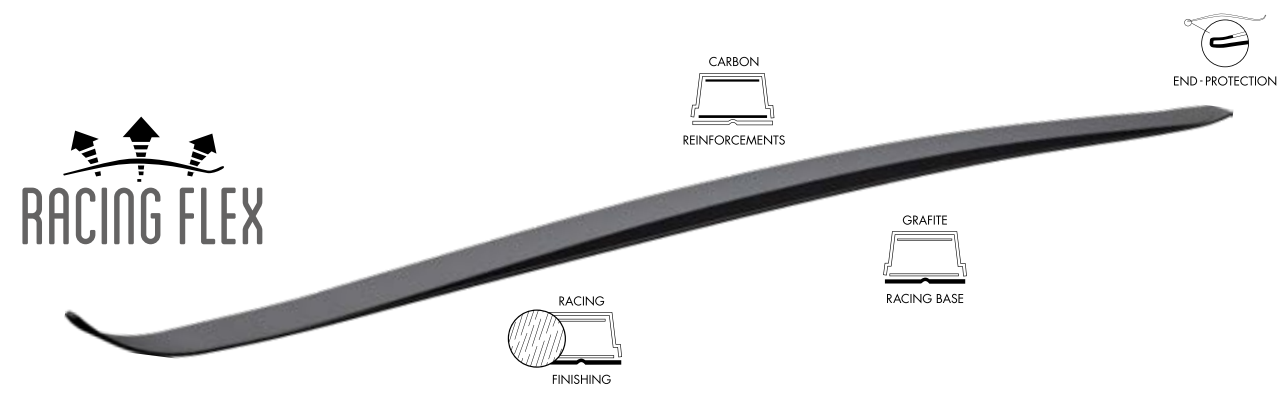

## TEAM COMP DUO SKIN cod. 12150

### COD. 12152 TEAM COMP DUO SKIN

Manoeuvrable, lightweight, waxless CLASSIC skis. The skis feature excellent grip and glide. Light wood, fiberglass and carbon Cap LiWood Tech structure. DUO SKIN technology with replaceable mohair skin inserts

### COD. 12152E TEAM COMP DUO SKIN EVO (KIT)

Manoeuvrable, lightweight, waxless CLASSIC skis. The skis feature excellent grip and glide. Light wood, fiberglass and carbon Cap LiWood Tech structure. DUO SKIN technology with replaceable mohair skin inserts. Kit of mohair inserts included.



KIT SKIN RACE+GRAPHITE BASE

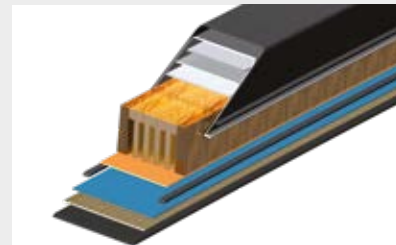

- . LIWOOD TECH
- . CARBON GLASS REINFORCEMENTS
- . END PROTECTION
- . RACING BASE
- . RACING FINISHING



SIZE	HARDNESS	SIDECUT	BASE/SKIN	WEIGHT
177 cm	soft	41.0	race universal	1080 gr
184 cm	medium	44.5	DUO SKIN 40 cm	size 198 cm
191 cm	hard	44.5	(191-198-205)	
198 cm			DUO SKIN 38 cm	
205 cm			(177-184)	

## TEAM COMP DUO SKIN JUNIOR cod. 12158

Waxless JUNIOR CLASSIC skis, easy to manoeuvre and lightweight. The skis feature excellent grip and glide. Light wood, fiberglass and carbon Cap LiWood Tech structure. DUO SKIN technology with replaceable mohair skin inserts.

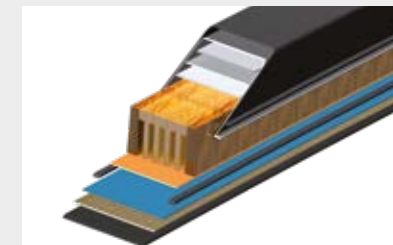

- . LIWOOD TECH
- . CARBON GLASS REINFORCEMENTS
- . END PROTECTION
- . RACING BASE
- . RACING FINISHING



SIZE	HARDNESS	SIDECUT	BASE/SKIN	WEIGHT
150 cm		41.0	race universal	810 gr
160 cm	medium	44.0	DUO SKIN 38 cm	size 160 cm
170 cm		44.0	(170)	
			DUO SKIN 36 cm	
			(150-160)	



## TEAM COMP DUO SKIN CARVE cod. 12160

Lightweight, waxless CLASSIC skis with utmost manoeuvrability and high stability. The skis feature excellent grip and glide. Lightwood, fiberglass and carbon Cap LiWood Tech structure. DUO SKIN technology with replaceable mohair skin inserts. Skis with shallow side-cut.

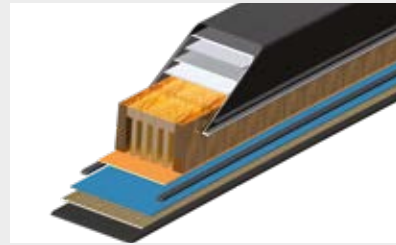

- . LIWOOD TECH
- . CARBON GLASS REINFORCEMENTS
- . END PROTECTION
- . RACING BASE
- . RACING FINISHING



SIZE	HARDNESS	SIDECUT	BASE/SKIN	WEIGHT
177 cm	soft	48.0	race universal	1120 gr
184 cm	medium	45.0	DUO SKIN 42 cm	size 198 cm
191 cm	hard	47.0	(191-198-205)	
198 cm			DUO SKIN 40 cm	
205 cm			(177-184)	



ELITE CLIP STRAP  
Cod.42052  
S-M/L-XL

FALCON CLIP HANDLE  
Cod.42050

## GARA AERO QC

**Cod. 41133**

Bastone da competizione in carbonio 100%. Manopola diametro 16.5mm, papera diametro 8.5mm.

100% carbon race pole. Handle diameter: 16.5 mm, basket diameter: 8.5 mm

Material: 100% Carbon  
Strap: Elite Clip  
Handle: Falcon Clip  
Basket: Tornado big QC  
Size: 130cm-170cm each 5 cm. Free 165-180  
Weight: 54 gr/m

QC QUICK SYSTEM  
42042 BASE AND NUT 8.5 mm  
42045 ROLLSKI TIP TORNADO 8.5 mm  
42044 BASKET TORNADO BIG 8.5 mm  
42054 BASKET TORNADO 8.5 mm







EVOLUTION CLIP STRAP  
Cod.42053  
XS-S-M/L-XL

FALCON CLIP HANDLE  
Cod.42050

## GARA AERO JUNIOR QC

Cod. 41135

Bastone da competizione Junior in carbonio 80%. Manopola diametro 16.5mm, papera diametro 9.5 mm.

*Junior race pole made from 80% carbon. Handle diameter: 16.5 mm, basket diameter: 9.5 mm*

Material: 80% Carbon  
Strap: Evolution Clip  
Handle: Falcon Clip  
Basket: Tornado big QC 9.5mm  
Size: 110cm-150cm each 5 cm. Free 125-135  
Weight: 73 gr/m

QC QUICK SYSTEM  
42042 BASE AND NUT 9.5 mm  
42045 ROLLSKI TIP TORNADO 9.5 mm  
42044 BASKET TORNADO BIG 9.5 mm  
42054 BASKET TORNADO 9.5 mm



ELITE CLIP STRAP  
Cod.42052  
S-M/L-XL

FALCON CLIP HANDLE  
Cod.42050

## TEAM COMP 90 QC POLES

Cod.41134

Bastone in carbonio 90%. Manopola diametro 16.5mm, papera diametro 9.5 mm. 90% carbon pole. Handle diameter: 16.5 mm, basket diameter: 9.5 mm

Material: 90% Carbon  
Strap: Elite Clip  
Handle: Falcon Clip  
Basket: Tornado big QC 9.5mm  
Size: 130cm-170cm each 5 cm.  
Weight: 73 gr/m

QC QUICK SYSTEM  
42042 BASE AND NUT 9.5 mm  
42045 ROLLSKI TIP TORNADO 9.5 mm  
42044 BASKET TORNADO BIG 9.5 mm  
42054 BASKET TORNADO 9.5 mm



WILLIE STRAP  
Cod.42059  
S-M/L-XL

WILLIE HANDLE  
Cod.42058

## TEAM COMP CARVE

Cod.41115

Bastone turistico in fibra di vetro e 17%carbonio . Manopola diametro 16.5mm, papera diametro 10 mm.  
*Recreational pole made from fiberglass and 17% carbon. Handle diameter: 16.5 mm, basket diameter: 10 mm.*

Material: Fiberglass + 17% Carbon  
Strap: Willie XC Clip  
Handle: Willie XC Clip  
Basket: Touring W 10 mm  
Size: 110cm-160cm each 5 cm.  
Weight: 84 gr/m



TOURING W BASKET  
Cod.42057



## GARA PLUS COD. 27194

Guanto da gara e allenamento con ottima vestibilità grazie alle dita preformate. Buona termicità.

*Race and training glove with a superior fit thanks to the preformed fingers. Good warmth.*

**Shell:** 3 Layer Polyester breathable soft shell, windproof  
**Liner:** 100% Greed Fleece on palm + 100% Plan Polyester liner on back  
**Palm:** Goat leather on fingers + Microfiber reinforcement + Nylon fabric  
**Insulation:** Light and warm greed fleece technology  
**Cuff:** Breathable Neoprene  
**Features:** Outside stitching on fingers for better fit + cuff puller  
**SIZE:** XS - S - M - L -XL - XXL



**WARMTH INDEX**  
-15°|-10°

**DRY TECHNOLOGY**  
WINDPROOF  
DURABLE WATER RESISTANCE

**INSULATION**  
LIGHT AND WARM FLEECE  
LIGHT INSULATION



## GARA LITE COD. 27191

Guanto da gara leggero con un'ottima traspirabilità; rinforzi in silicone sul palmo per garantire un buon grip sul bastone. Adatto per temperature non troppo rigide.

*Lightweight race glove offering excellent breathability, with silicone supports on the palm to guarantee grip; suitable for mild temperatures.*

**Shell:** 3 Layer Polyester breathable soft shell, windproof  
**Liner:** 100% Plan Polyester liner  
**Palm:** Reinforced Microfiber palm + gripping silicone  
**Insulation:** None  
**Cuff:** Anatomic elastic Lycra  
**Features:** Puller on cuff  
**SIZE:** S - M - L - XL



**WARMTH INDEX**  
-10°|0°

**DRY TECHNOLOGY**  
WATER AND WINDPROOF  
ON BACK

**INSULATION**  
NONE



## GARA OVERGLOVE WATERPROOF COD. 27176

Copriguanto completamente impermeabile ed antivento per garantire la massima protezione all'acqua, membrana traspirante e rinforzi in silicone sul palmo per un'ottimo grip.

*Completely waterproof and windproof overglove to guarantee maximum protection from the wet, breathable membrane and silicone reinforcements on the palm for excellent grip.*

**Shell:** 100% Nylon stretch fabric + high breathable membrane  
**Liner:** None  
**Palm:** 100% Nylon stretch fabric + high breathable membrane + silicone print  
**Insulation:** None  
**Cuff:** 100% Nylon stretch fabric + high breathable membrane + silicone print  
**Features:** Anatomic fit + puller on cuff  
**SIZE:** S - M - L



**WARMTH INDEX**  
-10°|0°

**DRY TECHNOLOGY**  
WINDPROOF  
HIGH DURABLE WATER RESISTANCE

**INSULATION**  
NONE





## NORDIC COD. 27185

Guanto con 5 dita con una buona termicità e ottima mobilità della mano grazie alla buona vestibilità e ai materiali molto morbidi, molto confortevole ed adatto sia per lo scialpinismo che per tutte le altre attività invernali quali sci nordico, salita con le ciaspole e nordic walking. *5-finger glove, very warm, excellent dexterity thanks to superior fit and soft fabrics; very comfortable and suitable for ski touring as well as other winter activities like cross-country skiing, snow shoeing and nordic walking.*

**Shell:** 100% Polyester sublimated  
**Liner:** 100% Plan Polyester Liner  
**Palm:** Reinforced Microfiber palm + silicone  
**Insulation:** Needle insulation back+palm  
**Cuff:** 100% Polyester Sublimated + Polyamide elastic material  
**Features:** Outside stitching + reinforced suede patch + nose cleaner  
**SIZE:** XS - S - M - L - XL - XXL

WARMTH INDEX  
-12°| -5°

INSULATION  
NEEDLE INSULATION



## K SPORT COD. 27195

Guanto molto leggero con cover in Lycra antivento e rinforzi al silicone sul palmo per aumentare il grip sul bastone - tecnologia touch per poter utilizzare smartphone con guanto indossato.

*Very lightweight glove with windproof lycra cover and silicone reinforcements on the palm for excellent grip – touch technology to use smartphone without taking it off.*

**Shell:** Polyester stretch knitted  
**Liner:** Polyester stretch knitted  
**Palm:** microfiber with silicon print for a better grip  
**Cuff:** Cover in nylon high density silver coating  
**Features:** windproof and waterproof cover + reflex piping  
**SIZE:** XS - S - M - L - XL

WARMTH INDEX  
-4°| 6°



## MITT MAXIMO CLASSIC COD. 27175

Innovativo guanto con dita in polartec e moffola apribile sulle dita che lo rende allo stesso tempo molto traspirante e caldo . Rinforzi in pelle sul palmo ed attorno al pollice che lo rendono oltre che confortevole anche resistente. La cover sulle dita è stata studiata per poter essere messa e tolta in un solo gesto.

*Innovative glove with polartec fingers and mitten flap cover that make it ideal for all conditions. Leather reinforcements on the palm and around the thumb make it both comfortable and durable. The cover on the fingers is designed to pull it on and off in one quick, easy movement.*

**Shell:** Very warm Polyester stretch knitted  
**Liner:** Light Polyester lining  
**Palm:** Microfiber reinforced with goat leather  
**Insulation:** None  
**Cuff:** Breathable Neoprene  
**Features:** Polyester windproof and waterproof cover+ fleece  
**SIZE:** XS - S - M - L - XL - XXL



WARMTH INDEX  
-16°| -6°

DRY TECHNOLOGY  
WINDPROOF.  
DURABLE WATER RESISTANT



## K LIGHT MITT COD. 27184

Moffola con una buona termicità, molto morbida e perfetta da utilizzare per la discesa, occupa pochissimo spazio ed offre un ottimo comfort. *Very soft, warm mitten, perfect for skiing, taking up little space and offering superb comfort.*

**Shell:** 100% Polyester fabric  
**Liner:** 100% Plan Polyester liner  
**Palm:** Polyuretan synthetic leather with Polyester base  
**Insulation:** Polyester Soft insulation 140 gr  
**Cuff:** 100% Polyester  
**Features:** Reinforced Goat leather patch  
**SIZE:** S - M - L - XL



WARMTH INDEX  
-15°| -5°

DRY TECHNOLOGY  
WINDPROOF  
DURABLE WATER RESISTANT

INSULATION  
LEVEL LOFT 140gr.



## WAIST BAG WATER BLADDER

**COD. 52085**

Marsupio borraccia isolata termicamente con diverse tasche per alloggiamento accessori.

*Thermal waist pouch flask holder with various pockets for storing accessories.*

CAPACITÀ / CAPACITY: 1LT  
TESSUTO / FABRICS: POLYESTER  
PESO / WEIGHT: 200 GR

WATER BLADDER  
KEY POCKET  
FOOD POCKET  
ELASTIC MESH MAIN POCKET  
SILICONE PRINT  
POLES SUPPORT



## SPRINT cod. 23081

Calzata ergonomica e volume ridotto all'essenziale per uno zaino in cui riporre lo stretto necessario. Zaino ideale per il running, bike e ski fitness.

*Ergonomic fit and reduced volume for a backpack where you can store the bare essentials. Ideal for running, cycling and fitness ski touring.*



**GARA**  
WATER BLADDER 1.5 LT  
cod. 23075



POLE SUPPORT



REMOVABLE SKI LOOP

ADJUSTABLE SHOULDER

ACCESSORY POCKET

NYLON WAIST BELT



POLE SUPPORT



EASY SKI SYSTEM WITH MOULDED HOOK

MAGNETIC CHEST LOCKING SYSTEM

PHONE POCKET

ELASTIC SHAPE FOR PERFECT FIT

EVA PADDED BACK

SKI HOLDER  
KEY POCKET  
ACCESSORY POCKET  
WATER BLADDER POCKET  
RIGID FIXING SYSTEM AT NECK LEVEL  
PADDED BACK  
MAGNETIC CHEST SYSTEM  
WALKING POLES DOUBLE SUPPORT

CAPACITÀ / CAPACITY: 12 LT  
TESSUTO / FABRICS: NYLON, POLYESTER  
PESO / WEIGHT: 300 GR

## GARA 2.0 cod. 23083

Zaino per gara ed allenamento rappresenta l'evoluzione dei modelli World Cup e Grande Course. Il pannello posteriore è montato su un telaio elastico per garantire una perfetta vestibilità. Baricentro alto di ispirazione trail per la migliore libertà di movimento. Doppio sistema di trasporto sci, tasca per pala lontano dalla schiena e porta piccozza.

*This race and training backpack is an evolution of the previous Grande Course and World Cup ones. The back protector is mounted on an elastic frame to adhere well to the body and for a perfect fit. Trail inspired high barycentre for complete freedom of movement. Double ski carrying system, shovel pocket away from your back, ice axe loop.*



**GARA**  
WATER BLADDER 1.5 LT  
cod. 23075  
**GARA BOTTLE**  
350 or 600 ML  
cod. 23073 or 23074

2ND SKI HOLDER  
CRAMPON POCKET  
ADJUSTABLE SKI HOLDER  
ICE AXE LOOP  
KEY POCKET  
SHOULDER POCKET  
WATER BLADDER POCKET  
ELASTIC FIXING SYSTEM AT CHEST LEVEL  
RIGID FIXING SYSTEM AT NECK LEVEL  
SHOVEL AND PROBE POCKET: AWAY FROM BACK  
SHOULDER POCKET WITH ZIP  
PADDED BACK  
FLASK POCKET  
MAGNETIC CHEST SYSTEM

Fabric by  
**LEVEL**

CAPACITÀ/ CAPACITY: 22LT  
TESSUTO / FABRICS: NYLON, POLYESTER, LYCRA  
PESO / WEIGHT: 390GR



CRAMPON POCKET  
DOUBLE SKI CARRYING SYSTEM  
SHOVEL/PROBE POCKET AWAY FROM YOUR BACK  
HIGH CAPACITY



KEY/ WALLET POCKET  
WATERPROOF ZIP  
WATER BLADDER POCKET  
ADJUSTABLE SHOULDER SIZE  
WATERPROOF FABRIC  
ADJUSTABLE SKI LOOP  
2ND SKI HOLDER  
FLASK POCKET  
SHOULDER POCKET

## MOUNTAIN T2 cod. 23080

Evoluzione diretta degli zaini race mantiene l'originale schienale a V ma abbinata una forma più classica ed un volume di carico superiore. Molto funzionale e pratico.

*The evolution of the race backpack, maintains the original V-shaped back protector, while adding a more classic shape and extra capacity. Very functional and practical.*



**GRANDE COURSE**  
WATER BLADDER 1.5 LT  
cod. 23076  
**GARA BOTTLE**  
350 or 600 ML  
cod. 23073 or 23074

2ND SKI HOLDER  
CRAMPON POCKET  
ADJUSTABLE SKI HOLDER  
ICE AXE LOOP  
KEY POCKET  
SHOULDER POCKET  
WATER BLADDER POCKET  
RIGID FIXING SYSTEM AT NECK LEVEL  
PADDED BACK  
FLASK POCKET  
MAGNETIC CHEST SYSTEM

CAPACITÀ/ CAPACITY: 25LT  
TESSUTO / FABRICS: NYLON, POLYESTER, LYCRA  
PESO / WEIGHT: 510GR



ICE AXE EMERGENCY POSITION  
SHOULDER BOTTLE HOLDER (2 size)  
EASY SKI SYSTEM WITH MOULDED HOOK  
ADJUSTABLE SHOULDER  
MAGNETIC CHEST LOCKING SYSTEM  
ACCESSORY POCKET  
MOUNTAIN BACK PANEL  
SKIN POCKET  
ADJUSTABLE SKI RING  
REINFORCED CRAMPON POCKET  
ICE AXE REGULAR POSITION  
NYLON WAIST BELT

## ORTLES 26 COD. 23084

Ortles è il nuovo zaino sviluppato per le tue avventure verticali sugli sci. Comfort e funzionalità con un occhio rivolto alla sicurezza. Progettato e realizzato dai professionisti dello sci alpinismo, quello vero.

*Ortles is the new backpack developed for your vertical adventures. Comfort and functionality with an eye for safety. Designed and made by true ski touring professionals.*



EVA BACK PANEL

HELMET NET HOUSING

VENTILATED AIR MESH POCKET

CAPACITÀ/CAPACITY: 26LT  
TESSUTO/FABRICS: EVA - NYLON - POLYESTER  
PESO/WEIGHT: 880 GR

### FEATURES

SAFETY POCKET WITH RED PULLER, OPENING FROM THE BOTTOM  
EVA BACK PANEL WITH TRANSPARATION HOLES  
DOUBLE ACCESS TO MAIN POCKET  
HELMET NET HOUSING  
VENTILATED AIR MESH POCKET  
SECONDARY POCKET WITH KEY HOOK  
SHAPED WAIST BELT WITH TWO POCKETS  
ASYMMETRICAL WAIST ADJUSTMENT  
DOUBLE LOOP FOR CARABINER  
SKI LOOP AND AXE LOOP  
SIDE SKI HOLDER  
BOTTLE POCKET ON BOTH SHOULDERS  
2 SIDE POCKETS  
MAGNETIC CHEST SYSTEM  
BOTTOM POCKET  
WATERPROOF ZIP

## ALTAVIA TRAVEL BAG/ BACKPACK 40 LT - COD. 52075

Borsa / Zaino con spallacci trasformabili in maniglie per il trasporto. Supporto posteriore 3D stampato in eva e nylon, con apertura a tutta lunghezza. 12 tasche oltre allo scomparto principale. Tasca esterna per documenti, vano per le scarpe. Fermo elastico  
*Bag/Backpack with shoulder straps convertible into carrying handles. Printed back support made of Eva and nylon, with full-length opening. 12 pockets in addition to the main compartment. External pocket for documents, shoe compartment. Elasticated retainer.*

CAPACITÀ/ CAPACITY: 40LT  
TESSUTO / FABRICS: EVA - NYLON  
TARAPULVIN  
PESO / WEIGHT: 1080 GR



POCKETS AND INNER ACCESSORIES

EXTERNAL POCKET

SBS ZIP



EVA MOULDED BACK PANEL

SOFT SHOULDERS MADE OF NEOPRENE + ELASTIC

## GARA DUFFLE COD. 52081

Borsa / Zaino con spallacci trasformabili in maniglie per il trasporto. Supporto posteriore 3D stampato in eva e nylon, con apertura a tutta lunghezza. 12 tasche oltre allo scomparto principale. Tasca esterna per documenti, vano per le scarpe. Fermo elastico  
*Bag/Backpack with shoulder straps convertible into carrying handles. Printed back support made of Eva and nylon, with full-length opening. 12 pockets in addition to the main compartment. External pocket for documents, shoe compartment. Elasticated retainer.*

ADJUSTABLE FOAM PADDED SHOULDERS  
HELMET POCKET  
FOAM PADDED SKI BOOT POCKET  
MAIN POCKET  
2 POCKETS ON BOTH SIDES

CAPACITÀ/ CAPACITY: 40LT  
TESSUTO / FABRICS: POLYESTER  
PESO / WEIGHT: 1000 GR



----- Helmet Pocket

## SKI COVER 164/178 cod. 52083

### FEATURES

Size: 164/178 - 192 and 205 cm



## ATTIVO SKI BAG cod. 52084

### FEATURES

Portasci regolabile *Adjustable ski bag.*  
Size: 171 - 186 - 205 cm



## GARA SKI TROLLEY BAG cod. 52080

### FEATURES

Capiente borsa portasci con trolley.  
*Large ski trolley bag.*  
Size: 205 cm



## ATTIVO SKI BOOT BAG cod. 52082

### FEATURES

Borsa scarponi con tasca esterna, piano appoggio rigido.  
*Ski boot bag with external pocket, stiff bottom.*



## NECK WARMER - Cod. 52057

### FEATURES

Polypropylene



## THERMO WAIST BAG cod. 52071

### FEATURES

Borraccia isolata termicamente.  
Tasca portaoggetti, cintura comfort.  
*Thermal flask, coin pocket, comfort belt.*



## XC SEPARATOR

Cod. PR14SEP



## SKI STRAP

Cod. PR17LAC\_ALP



## ELASTIC SKI STRAP 15 mm

Cod. PR14LAC



## SKI STRAP 40 mm

Cod. PR14LAC2

## SPRINT COD. 33023

Lampada a led compatta e leggera, dotata di 800 lumen. Consegnata con adattatore per il casco e una pratica fascia per l'utilizzo sulla testa senza casco.

La lampada emette un fascio di luce potente che permette di sciare con un'ottima visibilità.

Sulla parte superiore della lampada è presente il pulsante di accensione e scelta della modalità di funzionamento: 4 livelli di luminosità (max luminosità – 75% di luminosità – 50% di luminosità – luminosità ridotta ) e spenta.

Progettata per resistere nelle condizioni più estreme di utilizzo. Ricaricabile con cavo USB.

Peso: 86gr - Autonomia di 2 ore con luminosità al 50%

*Lightweight, compact 800 lumen led light.*

*Comes with helmet adapter and a practical headband for use without a helmet. The lamp emits a powerful beam of light that permits you to ski with excellent visibility.*

*The power switch is above the lamp and you can choose from 4 levels of brightness, (maximum, 75%, 50%, reduced) and off. Designed to withstand the most extreme conditions. Rechargeable with USB cable.*

*Weighs 86g, battery life 2 hours with 50% brightness.*



**ADHESIVE GOPRO HELMET SUPPORT** cod.33024  
**GOPRO HELMET SUPPORT BUCKLE** cod.33028  
**ELASTIC GOPRO HEADBAND** cod.33026

Material:  
Light Source: Cree XPG2 R5 LEDx2  
Luminous Flux: 800 Lm  
4 Intensity Level  
Weight: 86 gr  
Run Time: 2 h at 400 lm  
Removable Battery 1100mAh  
Materials: aluminium housing + ABS  
USB RECHARGEABLE  
POWER INDICATOR  
MODE MEMORY FUNCTION  
TEMP CONTROL DESIGN  
Standard and Gopro buckle  
ELASTIC GOPRO HEADBAND  
included Cod. 33026



**7.4 V - 4400 mAh BATTERY-** Cod. 33012  
**7.4 V - 2200 MAH BATTERY -** Cod. 33013  
**8.4 2A CHARGER -** Cod. 33014  
**3.7 V - 2200 mAh BATTERY 450 LM -** Cod. 33015  
**3.7 V CHARGER -** Cod. 33016

**GOPRO HELMET BUCKLE**



## AERO LAMP COD. 33020

Lampada a led compatta e leggera, perfetta per lo sci alpinismo, dotata di 2000 lumen. La lampada emette un fascio di luce potente che permette di sciare con un'ottima visibilità.

Sopra la lampada è presente il pulsante di accensione e scelta della modalità di funzionamento: 4 livelli di luminosità (max luminosità, 75% di luminosità, 50% di luminosità, luminosità ridotta ) e spenta. Lo stesso pulsante ha quattro led che indicano lo stato di carica delle celle così da indicare l'autonomia delle batterie.

Progettata per resistere nelle condizioni più estreme di utilizzo

*Lightweight, compact 2000 lumen led light, perfect for ski touring.*

*The lamp emits a powerful beam of light that permits you to ski with excellent visibility. The power switch is above the lamp and you can choose from 4 levels of brightness, (maximum, 75%, 50%, reduced) and off.*

*The same button has 4 LEDs that indicate the current charge level showing in this way the remaining battery life. Designed to withstand the most extreme conditions.*



**7.4 V - 4400 mAh BATTERY-** Cod. 33012  
**7.4 V - 2200 MAH BATTERY -** Cod. 33013  
**8.4 2A CHARGER -** Cod. 33014  
**3.7 V - 2200 mAh BATTERY 450 LM -** Cod. 33015  
**3.7 V CHARGER -** Cod. 33016

Light Source: 2xCREE XM-L U2 LEDs  
Luminous Flux: 2000 Lm  
Beam Distance : 200m  
4 Intensity Level  
Weight: 267 gr  
Case Material: 6061-T6 Aluminium Alloy  
Water resistance: IP66  
Impact resistance: 1M  
Run Time: 3 h at 2200 lm  
Removable Battery, Head Band  
Material: CNC-machined, Aluminium 6061-T6  
Aluminum alloy housing, anodized abrasion resistant finishing.  
Standard and Gopro buckle  
ELASTIC GOPRO HEADBAND  
included Cod. 33026



**ADHESIVE GOPRO HELMET SUPPORT**  
cod.33024

**GOPRO HELMET BUCKLE**  
cod.33028

**ELASTIC GOPRO HEADBAND**  
cod.33026





## BEANIE GARA COD. 85151

Cappellino con caratteristici colori Ski trab con stampa sublimata - i colori sono particolarmente brillanti - in Lycra con interno in light pile - perfetto anche da utilizzare come sottocasco.

*Innovative beanie using new Ski Trab Beanie in classic Ski Trab colours with sublimated print - the colours are particularly bright - in lycra with a light fleece lining - perfect for wearing under a helmets*

Material: 80% Polyester - 20% Elastane

## BAND GARA COD. 85152

Fascia con caratteristici colori Ski trab con stampa sublimata - i colori sono particolarmente brillanti - in Lycra con interno in light pile - perfetta anche da utilizzare come sottocasco

*Headband in classic Ski Trab colours with sublimated print - the colours are particularly bright - in lycra with a light fleece lining - perfect for wearing under a helmet.*

Material: 80% Polyester - 20% Elastane

## BEANIE GARA HIGH MOUNTAIN

COD. 85154

Berretto in Lycra foderato in caldo pile per garantire un'ottima termicità  
*Lycra beanie with fleece lining for extra warmth.*

Material: 82% Polyamide - 18% Elastane



## BEANIE GARA GRAN COURSE

COD. 85153

Cappellino con caratteristici colori Ski trab con grafica transfer 3D e con interno 3D fleece - i colori sono particolarmente brillanti  
*Beanie in classic Ski Trab colours with 3D graphic transfer and 3D fleece lining - extra bright colours*

Material: 50% Polyamide - 39% Polyester - 11% Elastane



Colore / Colour:

- 01
- 02

## BAND GARA HIGH MOUNTAIN

COD. 85155

Fascia in Lycra con interno doppio strato in pile, molto calda  
*Lycra headband with double layer fleece lining, very warm*

Material: 82% Polyester - 18% Elastane



## BAND GARA GRAN COURSE

COD. 85156

Fascia con caratteristici colori Ski trab con grafica transfer 3D e con interno 3D fleece - i colori sono particolarmente brillanti  
*Headband in classic Ski Trab colours with 3D graphic transfer and 3D fleece lining - extra bright colours*

Material: 50% Polyamide - 39% Polyester - 11% Elastane



Colore / Colour:

- 01
- 02



Colore / Colour:

- 01
- 02



Colore / Colour:

- 01
- 02

## ALTAVIA WOOL TECH BEANIE

COD. 85147

Innovativo berretto con nuova tecnologia Ski Trab Wolltech, leggero, caldo e traspirante

*Innovative beanie using new Ski Trab Wolltech technology, lightweight, warm and breathable.*

Material: 40% wool - 39% polypropylene - 21% polyamide  
Available in 3 different colours



Colore / Colour:  
● 01  
● 02  
● 04

## ALTAVIA WOOL TECH WARMER

COD. 85148

Innovativo scaldacollo con nuova tecnologia Ski Trab Wolltech, leggero, caldo e traspirante

*Innovative neck warmer using new Ski Trab Wolltech technology, lightweight, warm and breathable.*

Material: 40% wool - 39% polypropylene - 21% polyamide  
Available in 3 different colours

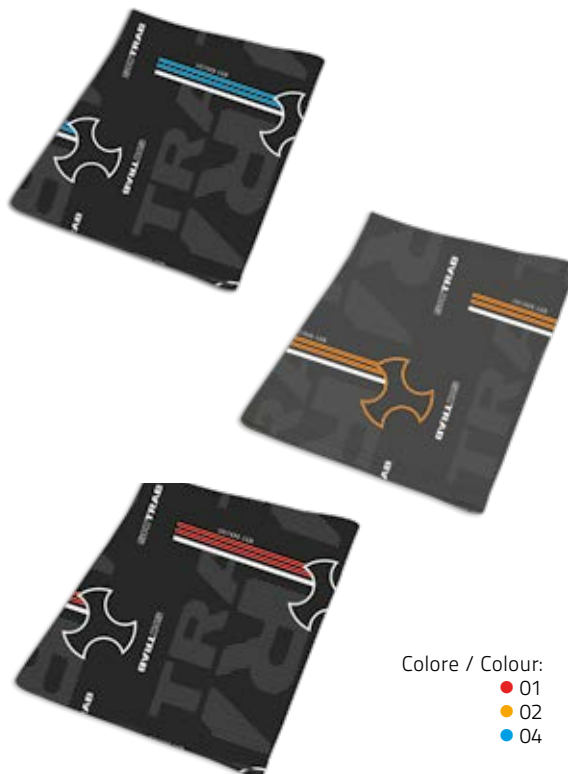

Colore / Colour:  
● 01  
● 02  
● 04

## ALTAVIA WOOL TECH TOTAL

COD. 85149

Innovativo passamontagna con nuova tecnologia Ski Trab Wolltech, leggero, caldo e traspirante - è possibile utilizzarlo anche come berretto.

*Innovative balaclava using new Ski Trab Wolltech technology, lightweight, warm and breathable - can also be used as a beanie.*

Material: 40% wool - 39% polypropylene - 21% polyamide  
Available in 3 different colours

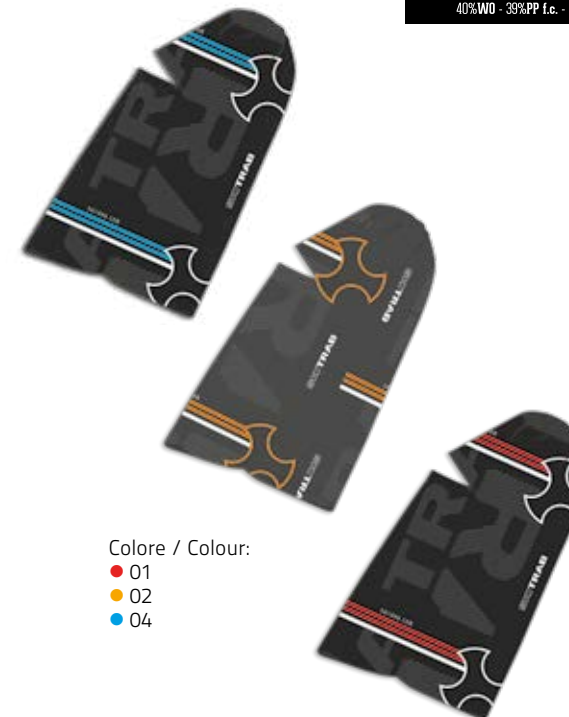

Colore / Colour:  
● 01  
● 02  
● 04

## ALTAVIA WOOL TECH BAND

COD. 85150

Innovativa fascia con nuova tecnologia Ski Trab Wolltech, leggera, calda e traspirante

*Innovative headband using new Ski Trab Wolltech technology, lightweight, warm and breathable.*

Material: 40% wool - 39% polypropylene - 21% polyamide  
Available in 3 different colours



Colore / Colour:  
● 01  
● 02  
● 04

## BEANIE BRAND COD. 85158

Cappuccia in lana con lavorazione Jacquard con logo Ski Trab con colori a contrasto.

*Wool beanie with jacquard pattern and Ski Trab logo in contrasting colours.*

Material: 50% wool - 50% Acrylic



Colore / Colour:

- 01
- 02
- 03



## BAND BRAND COD. 85157

Fascia alta in lana con lavorazione Jacquard con interno in pile - scritta grande Ski Trab con colori a contrasto

*Wool headband with jacquard pattern and fleece lining - large Ski Trab logo in contrasting colours*

Material: 50% wool - 50% Acrylic



Colore / Colour:

- 01
- 02
- 03



## BEANIE SUPERMAXIMO 3.0

COD. 85141

Berretto in Lana con punto a grana di riso - interno in pile per garantire un'ottima termicità

*Moss stitch wool beanie with fleece lining to guarantee extra warmth*

Material: 50% wool - 50% Acrylic

Inner: 100% Polyester

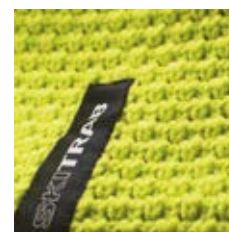

Colore / Colour:

- 01
- 02
- 03
- 05



## BAND SUPERMAXIMO 3.0

COD. 85143

Fascia in Lana con punto a grana di riso - interno in pile per garantire un'ottima termicità

*Moss stitch wool headband with fleece lining to guarantee extra warmth*

Material: 50% wool - 50% Acrylic

Inner: 100% Polyester

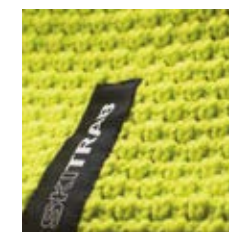

Colore / Colour:

- 01
- 02
- 03
- 05



## BEANIE STELVIO COD. 85145

Berretto in Lana con lavorazione lana a coste larghe e con interno in pile con colori a contrasto  
*Ribbed wool beanie with fleece lining and contrasting colours.*

Material: 50% wool - 50% Acrylic  
Inner: 100% Polyester



Colore / Colour:

- 01
- 02
- 03
- 04



## BAND STELVIO COD. 85146

Fascia in Lana con lavorazione lana a coste larghe e con interno in pile con colori a contrasto  
*Ribbed wool headband with fleece lining and contrasting colours*

Material: 50% wool - 50% Acrylic  
Inner: 100% Polyester



Colore / Colour:

- 01
- 02
- 03
- 04



## BEANIE VARIO COD. 85144

Cappellino in lana monocolore  
*Monochrome wool beanie*

Material: 50% wool - 50% Acrylic



Colore / Colour:

- 01
- 02
- 03



## SOCKS ALPIK

COD. 84154 long- COD. 84155 short

La costruzione in maglia rasata ed elasticizzata sul gambale e piede ne favorisce la massima precisione di calzata e un anti-rollio dinamico.

Le parti del piede di maggior contatto e frizione come, punta, tallone, collo del piede e tendine d'achille sono realizzate in morbida spugna di Merino, seta e Polipropilene che garantiscono massimo confort, buona azione anti-vesciche e favoriscono un microclima ideale per il benessere generale. Leggera, resistente e grazie all'accoppiata della lana Merino e seta con il Polipropilene, è molto coibente traspirante e facile da lavare a 30° come tutti i capi tecnici.

*Knitted in stockinette stitch, with elasticised leg and foot, offering a precise fit. They don't roll down your leg at all. The parts of the foot with greater contact and friction like toes, heel, instep and Achilles tendon are made of a soft Merino wool, silk and polypropylene blend that guarantees maximum comfort, protection from blisters providing an ideal microclimate for general well-being. Lightweight, resistant and, thanks to the blending of merino wool and silk with polypropylene, insulating, breathable and easy to wash at 30° like all technical sportswear.*

Material: fine merino, silk and polypropylene blend.

SIZE: 35/37 - 38/42 - 41/43 - 44/46



## BEANIE VARIO COD. 85144

Cappellino in lana monocolore  
*Monochrome wool beanie*

Material: 50% wool - 50% Acrylic



Colore / Colour:

- 01
- 02
- 03



## SOCKS ALPIK

COD. 84154 long- COD. 84155 short

La costruzione in maglia rasata ed elasticizzata sul gambale e piede ne favorisce la massima precisione di calzata e un anti-rollio dinamico. Le parti del piede di maggior contatto e frizione come, punta, tallone, collo del piede e tendine d'achille sono realizzate in morbida spugna di Merino, seta e Polipropilene che garantiscono massimo confort, buona azione anti-vesciche e favoriscono un microclima ideale per il benessere generale. Leggera, resistente e grazie al accoppiata della lana Merino e seta con il Polipropilene, è molto coibente traspirante e facile da lavare a 30° come tutti i capi tecnici.

*Knitted in stockinette stitch, with elasticised leg and foot, offering a precise fit. They don't roll down your leg at all. The parts of the foot with greater contact and friction like toes, heel, instep and Achilles tendon are made of a soft Merino wool, silk and polypropylene blend that guarantees maximum comfort, protection from blisters providing an ideal microclimate for general well-being. Lightweight, resistant and, thanks to the blending of merino wool and silk with polypropylene, insulating, breathable and easy to wash at 30° like all technical sportswear.*

Material: fine merino, silk and polypropylene blend.  
SIZE: 35/37 - 38/42 - 41/43 - 44/46



## GARA AERO JACKET 2.1 COD. 84162

Giacca impermeabile in Nylon waterproof richiudibile in un piccola e compatta tasca. Cuciture termonastrate.  
*Waterproof packable jacket made of nylon that folds into a small, compact pocket. Heat-taped seams.*

## GARA AERO PANT 2.1 COD. 84163

Pantalone impermeabile in nylon con zip laterali. Cuciture termonastrate.  
*Waterproof nylon pants with lateral zips. Heat-taped seams.*

Material: 100% NYLON - WP: 15.000 - MVTR: 15.000  
SIZE: XS - S - M - L - XL - XXL

## FLEECE BORMIO MAN COD. 84165 FLEECE BORMIO WOMAN COD. 84166

Fleece in Poliestere e Spandex versione uomo e donna.  
Men's and women's Polyester and Spandex Fleece.



Colore / Colour:  
● MAN  
● WOMAN



Material: 90% Polyester, 10% Spandex, breathable insulating dynamic fabric.  
SIZE MEN: S - M - L - XL - XXL - XXXL  
SIZE WOMEN: XS - S - M



## GARA XC TRACK SUIT MAN

SIZE: S - M - L - XL - XXL - cod. 83103

SIZE Junior: S - M - L - cod. 83104

Tuta due pezzi da fondo in Lycra Meryl e rinforzi in cordura stretch, zip ykk, zip diagonale ergonomica.

*Two-piece racing suit designed for nordic ski made of Lycra Meryl with cordura stretch reinforcements, ykk zip, ergonomic diagonal zip.*

### Materiale / Material:

Schoeller® ITD ProTec: blend of Carbon yarns and ceramic prints provides a fabric with very high abrasion resistance, especially in the case of high speed crashes. Lycra, Meryl, cordura stretch, ykk zip



## GARA JACKET

SIZE woman: XS - S - M - L - cod. 83109

SIZE man: S - M - L - XL - XXL - cod. 83108

SIZE junior: S - M - L - cod. 83110



## GARA PANT ZIP 3/4

SIZE woman: XS - S - M - L - cod. 83106

SIZE: man S - M - L - XL - XXL - cod. 83105

SIZE Junior: S - M - L - cod. 83107

## GARA VEST cod. 83111

SIZE: XS - S - M - L - XL - XXL

## GARA VEST JUNIOR cod. 83112

SIZE: XS - S - M

## AGENTS 2021/22 WORLDWIDE

### CANADA

ATHLETIC DIRECTIONS OF CANADA INC

372 Riedeau St. - Suite 226

Ottawa, ONT K1N 147

Tel 8196554715

email info@veresports.ca

### NORWAY

NQ ACTIVE AS

Løxaveien 17 - N-1351 RUD

Tel +47 21 95 02 95

post@nqsport.no

WWW.nqsport.no

### RUSSIA

SKIWAX SPORT

Kozhevnickeskaya str. 7/1,

TH "Kozhevniki", 4th floor - 115114 Moscow

Tel +7 985 233 39 63

skiwax@mail.ru

### USA/CANADA

VARALDI VINCENT

27 Chemin des étoiles - Eastman JOE 1P0 QC Canada

Tel. +1 819 578 4345 - email: vincent.varaldi@gmail.com

## AGENTS 2021/22 ITALY

### SKI TRAB SRL

Via Battaglion Tirano, 6 - 23032 Bormio (SO)

Tel. +39 0342 901650 - Fax +39 0342 905178

info@skitrab.com

### LOMBARDIA-PIEMONTE-VALLE D'AOSTA-LIGURIA

GIOVANNI FRANGI

Mob. +39 346 4270776

sport@frangi.net

### TRENTINO ALTO ADIGE-VENETO-FRIULI VENEZIA

GIULIA- EMILIA ROMAGNA

MAURO MADDALOZZO

Mob. 328 0305524 - Fax +39 0439 59106

madservice.ski@gmail.com

### LAZIO-UMBRIA-ABRUZZO

PIERO DI BIASE

Tel./Fax 0862.917547 - Cell. 339.4468646

pierodibiase@alice.it



## **SKITRAB SRL**

Via Btg. Tirano, 6  
23032 Bormio (SO)  
P.IVA 00757150149  
[www.skitrab.com](http://www.skitrab.com)  
[info@skitrab.com](mailto:info@skitrab.com)

 SKI TRAB

 skitrab\_srl

**SKITRAB**